

**JUST
GO
FOR IT!**

**CLEVELAND
PARK**

2 BHK Apartments
Opp. Corinthians Club Main Gate



WING A - ODD FLOOR PLAN



18 M WIDEROAD

TYPICAL ODD FLOOR PLAN (3rd, 5th, 7th, 9th, 11th)

FLAT NO.	CARPET AREA (SQ. M.)	TERRACE (100%) (SQ. M.)	DRY TERRACE (100%) (SQ. M.)	ENCLOSED BALCONY (SQ.M.)	CARPET AREA (SQ.M.)
A - 301, 501, 701, 901, 1101	58.88	10.66	2.09	9.05	80.68
A - 302, 502, 702, 902, 1102	58.89	10.66	2.09	9.05	80.69
A- 303, 503, 703, 903, 1103	62.40	10.70	2.09	5.25	80.44
A - 304, 504, 704, 904, 1104	58.80	10.70	2.09	9.05	80.64

WING A - EVEN FLOOR PLAN



18 M WIDEROAD



TYPICAL EVEN FLOOR PLAN (4th, 6th, 10th)

FLAT NO.	CARPET AREA (SQ. M.)	TERRACE (100%) (SQ. M.)	DRY TERRACE (100%) (SQ. M.)	ENCLOSED BALCONY (SQ.M.)	CARPET AREA (SQ.M.)
A - 401, 601, 1001	59.45	12.82	2.09	9.05	83.41
A - 402, 602, 1002	59.75	15.14	2.09	9.05	86.03
A- 403, 603, 1003	63.47	12.93	2.09	5.25	83.74
A - 404, 604, 1004	59.45	12.93	2.09	9.05	83.52

WING B - ODD FLOOR PLAN



18 M WIDEROAD

TYPICAL ODD FLOOR PLAN (3rd, 5th, 7th, 9th, 11th)

FLAT NO.	CARPET AREA (SQ. M.)	TERRACE (100%) (SQ. M.)	DRY TERRACE (100%) (SQ. M.)	ENCLOSED BALCONY (SQ.M.)	CARPET AREA (SQ.M.)
B - 301, 501, 701, 901, 1101	58.89	10.66	2.09	9.05	80.69
B - 302, 502, 702, 902, 1102	53.01	8.33	2.09	14.88	78.31
B - 303, 503, 703, 903, 1103	53.01	8.37	2.09	14.88	78.35
B - 304, 504, 704, 904, 1104	58.89	10.70	2.09	9.05	80.73

WING B - EVEN FLOOR PLAN



18 M WIDEROAD



TYPICAL EVEN FLOOR PLAN (4th, 6th, 10th)

FLAT NO.	CARPET AREA (SQ. M.)	TERRACE (100%) (SQ. M.)	DRY TERRACE (100%) (SQ. M.)	ENCLOSED BALCONY (SQ.M.)	CARPET AREA (SQ.M.)
B - 401, 601, 1001	59.45	12.82	2.09	9.05	83.41
B - 402, 602, 1002	53.88	12.82	2.09	14.88	83.67
B - 403, 603, 1003	53.88	12.93	2.09	14.88	83.78
B - 404, 604, 1004	59.45	12.93	2.09	9.05	83.52

ISOMETRIC VIEW - ODD FLOOR

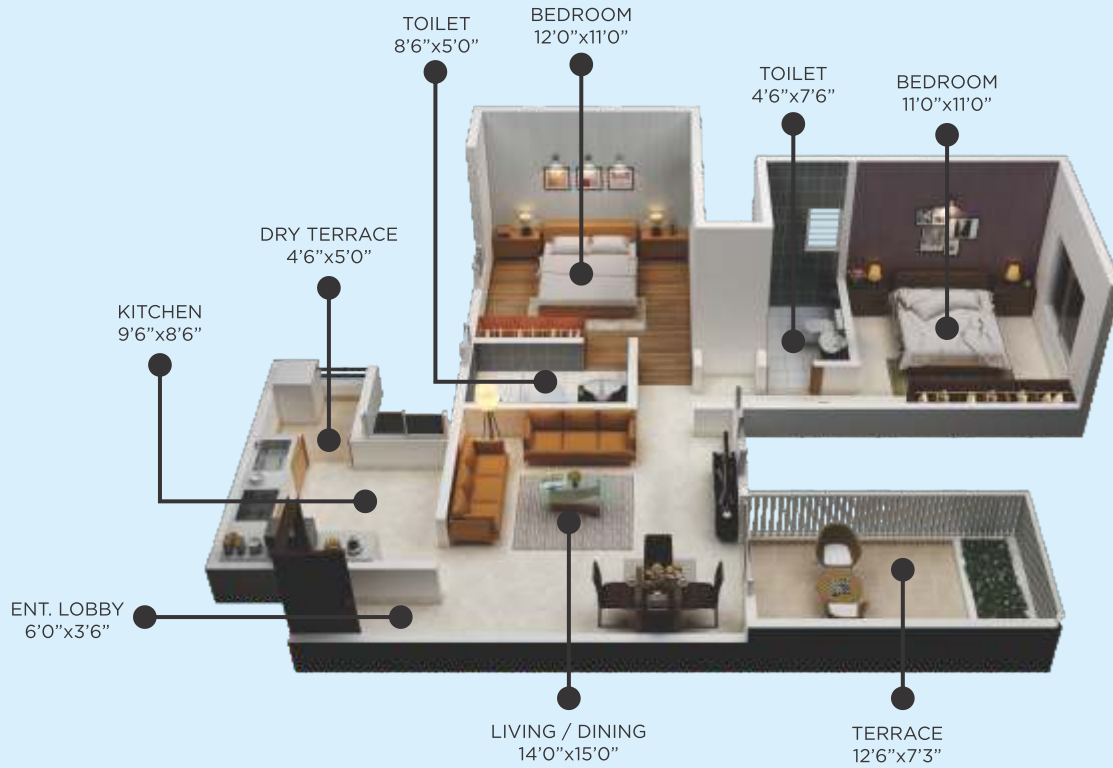

ISOMETRIC VIEW - EVEN FLOOR





SPECIFICATIONS

Flooring

- 2x2 Premium Vitrified Tiles

Wall Finishing and Painting

- Internal P.O.P Wall Finishing
- OBD Paint
- Weather Proof Superior Quality Exterior Paint

Kitchens

- Granite Platform with S.S. Sink
- Provision for Modular Kitchen Trolley
- Provision for Exhaust Fan & Water Purifier
- Provision for Chimney Hub

Electrification

- Concealed Electrification with Circuit Breakers
- Modular Switches
- Provision for Invertor

Washrooms

- Anti-Skid Flooring
- Dado Tilling
- Designer Sanitaryware C.P Fitting

Windows

- Aluminum Powder Coated Windows with Mosquito Nets

Safety & Security

- Safety Grills for Windows
- Video Door Phone System

Others

- Firefighting Systems
- Designer Name Plates for Every Apartment
- Designer Society Main Entrance Gate with Watchman's Cabin
- Earthquake Resistance Structure

Planning Highlights

- Large Open Spaces
- Meticulously Planned

AMENITIES

- A/C Clubhouse
- Gymnasium
- Party Lawn with Barbecue Area
- Swimming Pool
- Jogging Track
- 24x7 Two Tier Security
- Video Door Phone
- Amphitheater



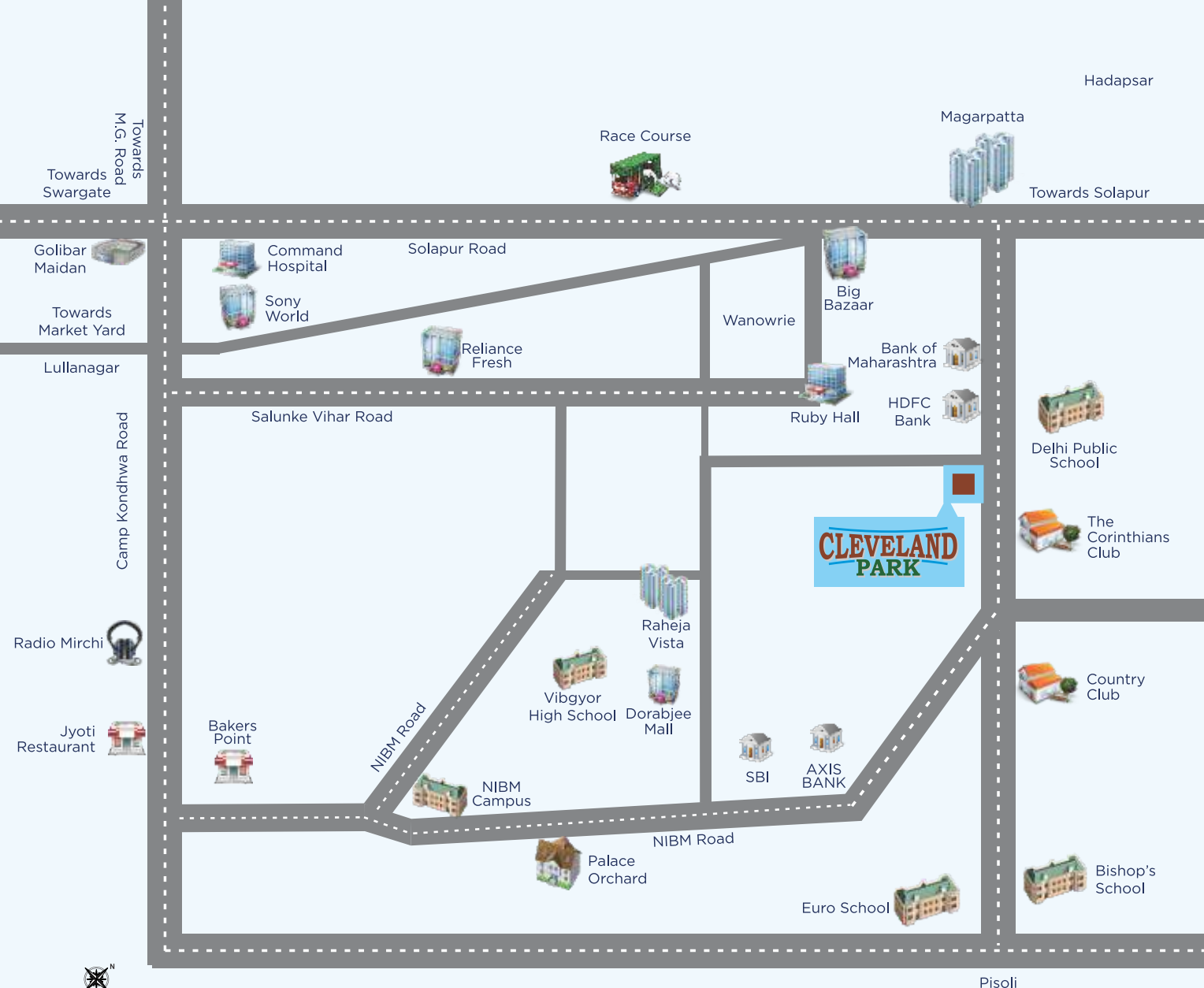

Map not to scale

Map not to scale

Cleveland Park is located off NIBM Road, opp. Corinthians Club, a prime location of Pune, with abundance of comforts at your disposal. Be it lifestyle or connectivity to all the hotspots of city. Or leisure in terms of malls & multiplexes, the best of healthcare and education in terms of the finest of schools, it's all there!

KEY DISTANCES:

- **SCHOOLS**
 DPS School: 1.0 km.
 Vibgyor School: 1.8 kms.
 Bishop's School: 1.0 km
 Euro School: 1.5 kms.
- **LEISURE & SHOPPING**
 Dorabjee Mall: 1.8 kms.
 Jyoti Restaurant: 4.0 kms.
 Corinthians Club: 65 mts.
 Country Club: 1.4 kms.
 Royal Heritage Mall: 1.8 kms.
- **BANKS**
 HDFC Bank: 450 mts.
 SBI: 900 Mts.
 ICICI Bank ATM: 100 mts.
 Bank of Maharashtra: 600 mts.
 AXIS Bank: 550 mts.
- **HOSPITALS**
 Ruby Hall: 11.2 kms.
 Desai Eye Hospital: 1.2 kms.
 Noble Hospital: 6.1 kms.
 Command Hospital: 7.7 kms.
 (For Defence Personnel)



Vardaan™
 A MITTAL VENTURE

E: sales@vardaanrealty.com
 W: www.vardaanrealty.com
 M: 9595 42 44 55

PROJECT APPROVED BY



The project has been registered via
 MahaRERA registration numbers: P52100003050
 and is available on the website
<https://maharera.mahaonline.gov.in/> under registered projects.