

**Rustomjee<sup>®</sup>**  
**SUMMIT**  
BORIVALI (E)



## **BOMAN IRANI**

CHAIRMAN & MANAGING DIRECTOR - RUSTOMJEE

"It gives us immense pleasure to be back in Borivali with our latest residential project - Rustomjee Summit, with great views, thoughtfully designed homes and delightful amenities. We're happy to be home, because home is where our heart is."



SHOT AT LOCATION  
DESIGNER ENTRANCE LOBBY



ACTUAL IMAGE

**IN A CITY THAT  
DOESN'T UNDERSTAND THE CONCEPT  
OF PERSONAL SPACE,  
PRESENTING A HOME THAT DOES.**

**COSY, YET SPACIOUS.  
AS CLOSE TO THE CITY AS IT IS AWAY FROM IT.  
LUXURIOUS, BUT AFFORDABLE.  
AREN'T CONTRADICTIONS LOVELY?**

Situated in Borivali (E), just minutes away from major arteries such as the Western Express Highway, S.V. Road & Link Road, Rustomjee Summit stands where two worlds meet.

Its thoughtfully designed 2 and 3 BHK homes, idyllic gardens, and options to unwind, offer the best possible slice of city life in a neighbourhood that gives you every reason to step out, and a home that you will want to hurry back to.

#### PROJECT DETAILS

Thoughtfully designed 2 and 3 bedroom homes

Safety and security features

Within easy reach of the East West Flyover

Excellent connectivity to the Western Railway, proposed metro station and Western Express Highway

Designer entrance lobby

Intercom facility & CCTV

Kids' play area

Sky Garden

#### LIFESTYLE AMENITIES

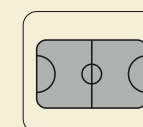

MULTI PLAY COURT



GYMNASIUM



MULTI FUNCTION ROOM



SWIMMING POOL



INDOOR GAMES ROOM



SEMI MODULAR KITCHEN



VIDEO DOOR PHONE



CCTV IN SELECT COMMON AREAS





**ANY WAY YOU LOOK AT IT,  
THIS IS THE KIND OF PLACE YOU'D  
BE PROUD TO CALL HOME.**

Located in the bustling suburb of Borivali East, Rustomjee Summit offers you a lifestyle most people can only dream of. A neighbourhood with every reason to step out, a home that you will want to hurry back to. What's more, the Sanjay Gandhi National Park is next door. Which means your kids can see animals for real, rather than in a picture book.









THE NEIGHBOURHOOD IS NOT SHORT OF ATTRACTIONS LIKE MALLS, RESTAURANTS AND SCHOOLS OR DEER, FLYING FOXES, PEACOCKS, LEOPARDS AND TIGERS.

### CONNECTIVITY

Western Express Highway | Link Road | S. V. Road

### PROPOSED METRO STATION

At Western Express Highway and Link Road

### EDUCATION

Rustomjee International School | Rustomjee Business School | Thakur School  
Don Bosco School | Ryan International School | L. N. College

### HEALTHCARE

Crystal Hospital | Dhanashri Hospital | Arihant Heart Clinic

### RETAIL & ENTERTAINMENT

Westside | Pantaloons | Metro Cash and Carry | Western Edge 2

### SANJAY GANDHI NATIONAL PARK

### BORIVALI STATION

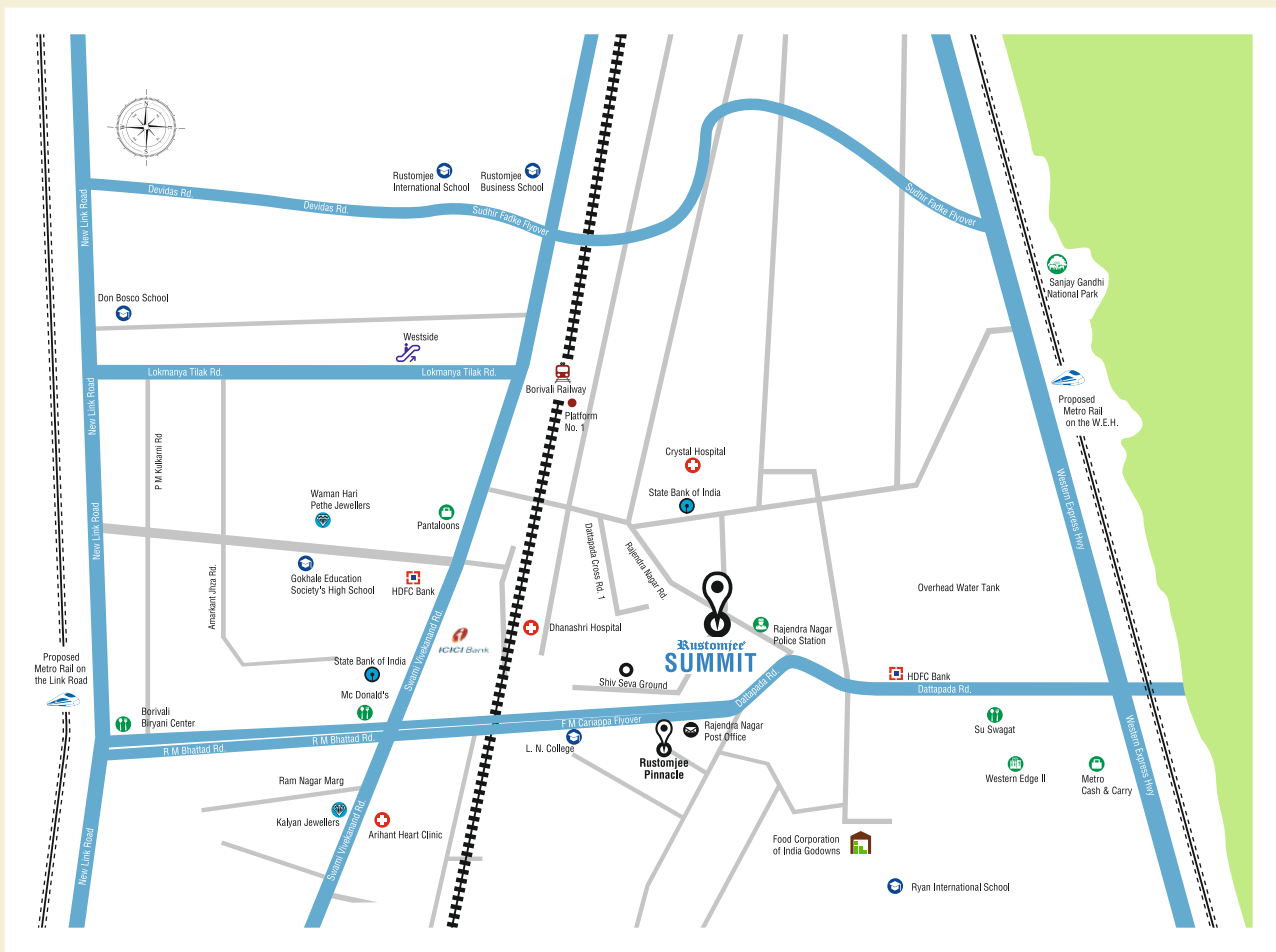

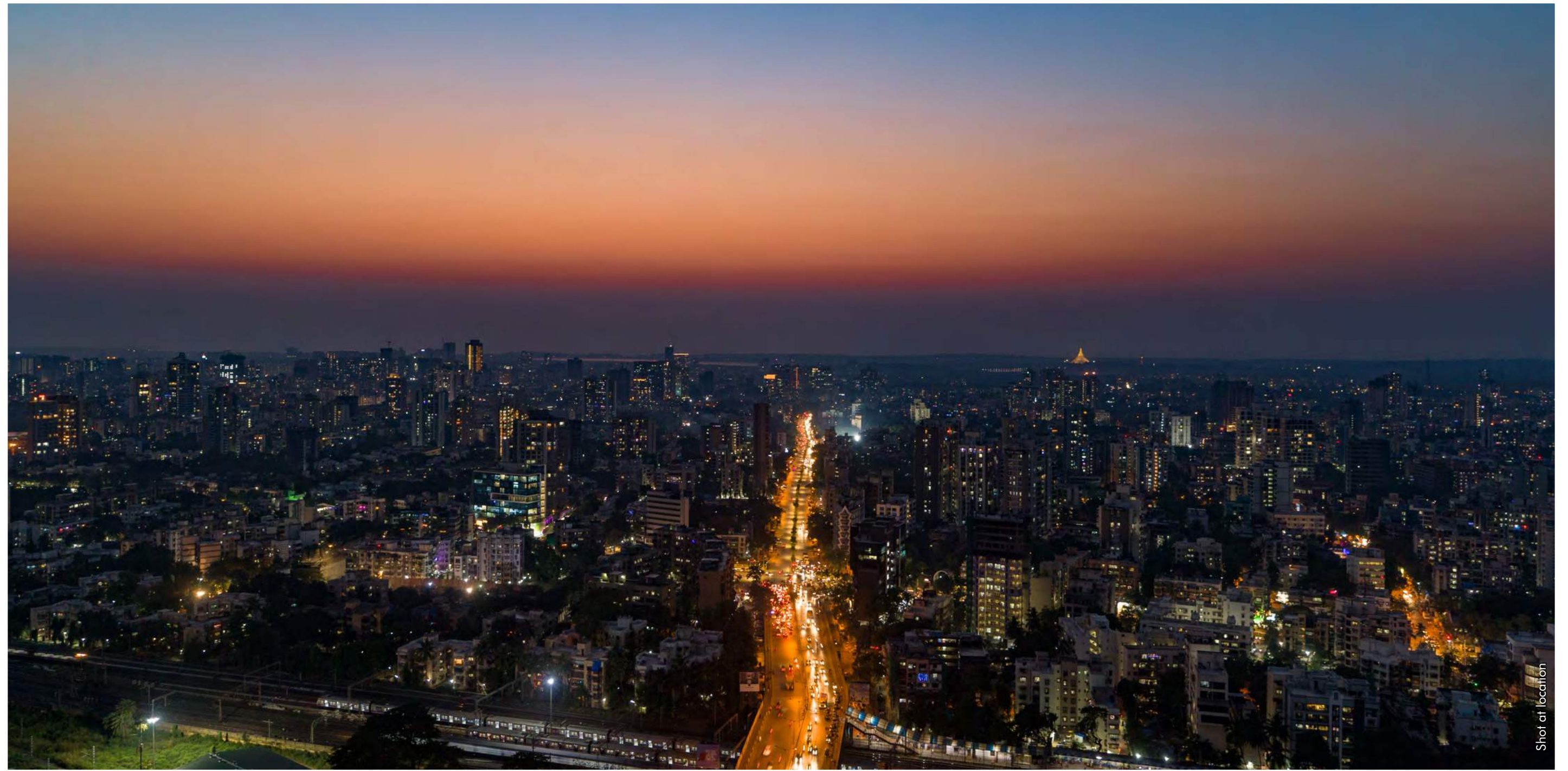
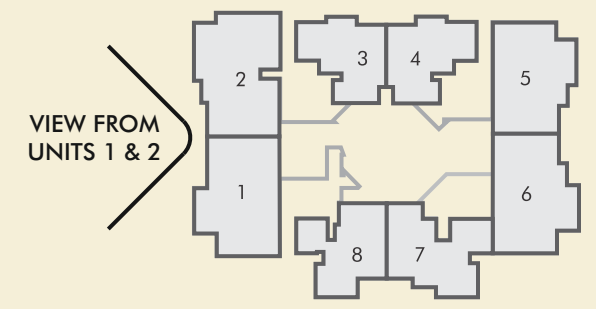

Shot at location



VIEW FROM  
UNITS 3 & 4

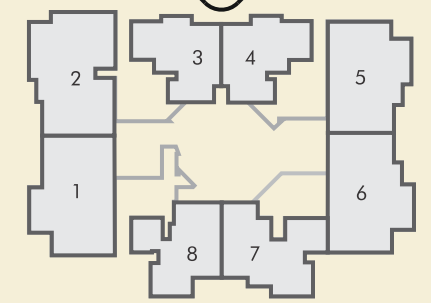

Shot at location



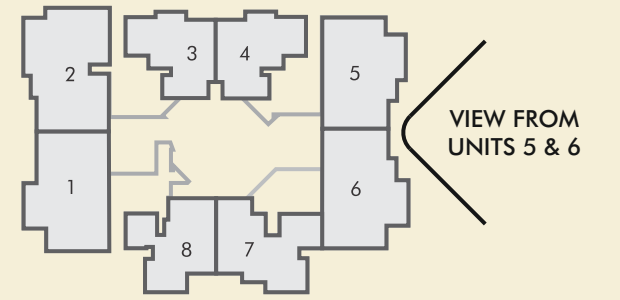

Shot at location



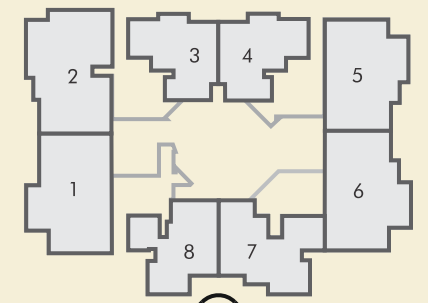

VIEW FROM  
UNITS 7 & 8



Shot at location



# FOR THE FORTUNATE FEW, HAVING IT ALL IS JUST A MATTER OF COMING HOME.

## INTERNAL AMENITIES

SEMI MODULAR KITCHEN | IMPORTED MARBLE IN LIVING AND  
DINING AREAS AND PASSAGE | VITRIFIED TILES IN KITCHEN AND ALL BEDROOMS  
CERAMIC TILES IN ALL TOILETS | LAMINATED FLUSH DOOR  
PREMIUM CP FITTINGS - JAQUAR OR EQUIVALENT  
AMERICAN STANDARD OR EQUIVALENT SANITARY WARE | VIDEO DOOR PHONE

## EXTERNAL AMENITIES

SWIMMING POOL | GYMNASIUM | MULTI FUNCTION ROOM | INDOOR GAMES ROOM  
LANDSCAPED GARDEN WITH MULTI PLAY COURT | CCTV IN KEY COMMON AREAS





# SWIMMING POOL

There's nothing a swim after hours can't undo.



Artist's Impression



## MULTI FUNCTION ROOM

It's Wednesday. There's a new season to binge watch. You got off early from work. In case you needed an excuse to throw a party.





## INDOOR GAMES ROOM

Give the neighbours a masterclass in competitiveness.





# GYMNASIUM

The secret to loving what you see in your mirror: the treadmill.

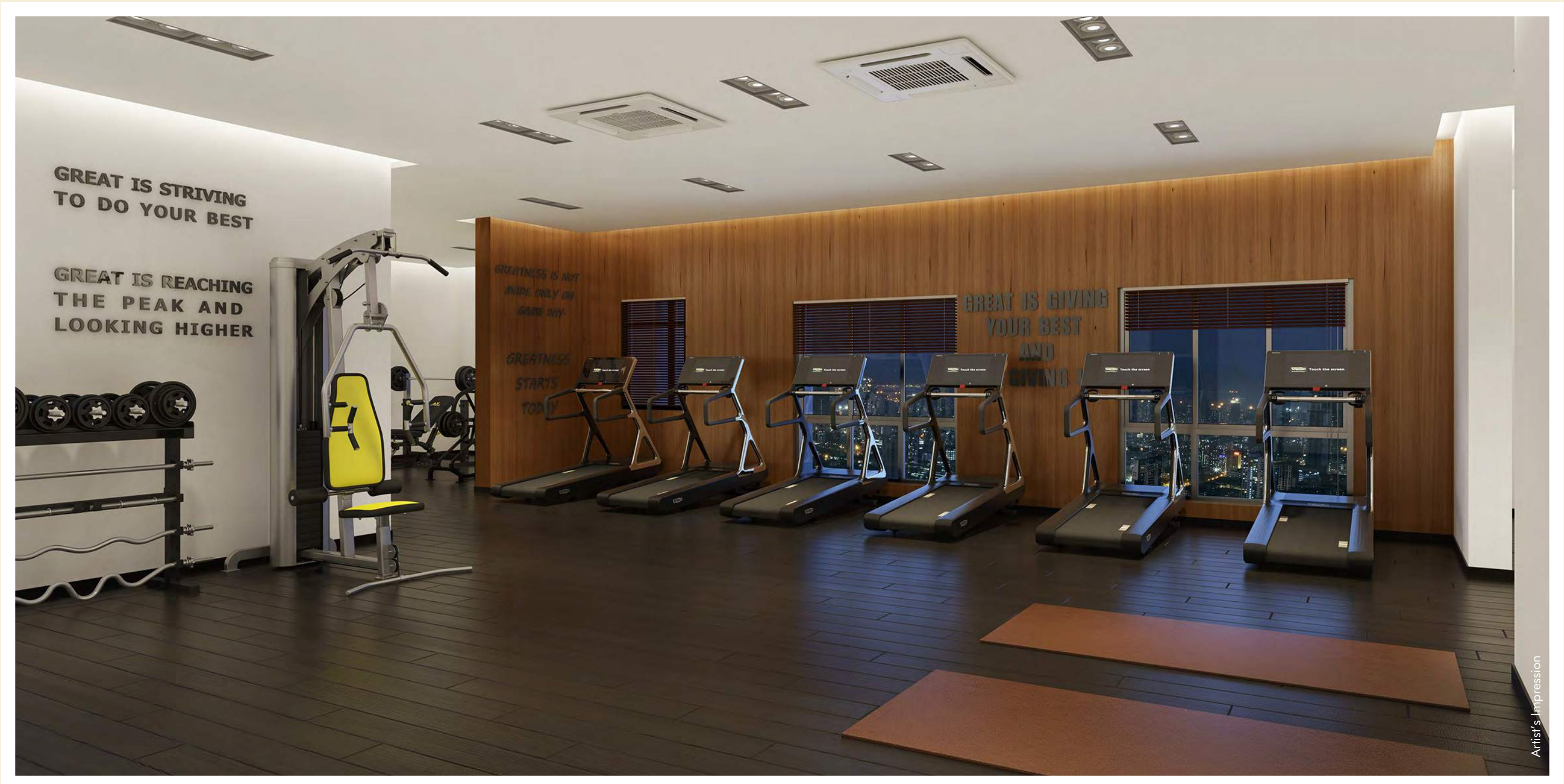



# MULTIPLAY COURT

Your most important appointment of the day: football with the kids.





IF ALL THIS WAS NOT ENOUGH, HERE'S ONE MORE PROFITABLE REASON TO OWN A HOME AT RUSTOMJEE SUMMIT

WHAT COULD BE BETTER THAN WATCHING YOUR KIDS GROW UP HERE? WATCHING YOUR INVESTMENT GROW TOO.

Owning a home here is an investment not only in your children's happiness, but in their future as well. After all, prices in Borivali East have been appreciating steadily for a decade. And with infrastructure like the proposed metro at Link Road and the Western Express Highway coming soon, this upward trend is likely to receive a significant boost. Which is why you should consider booking your residence now. It's a decision that will only get better with time.

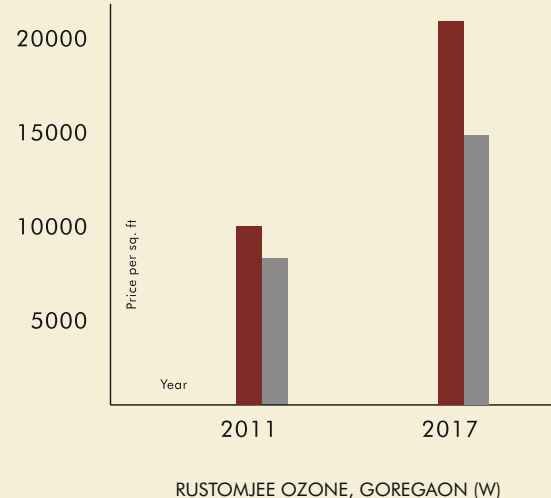
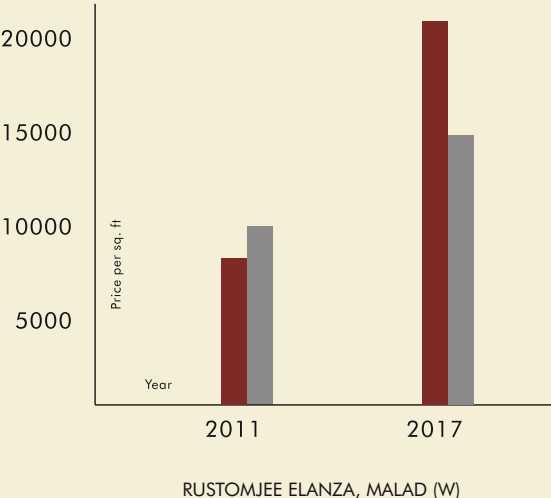
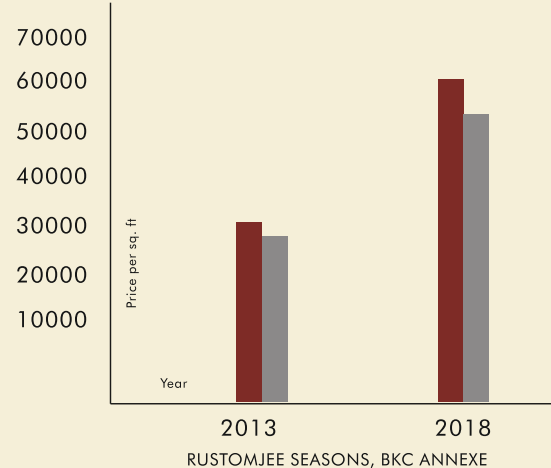
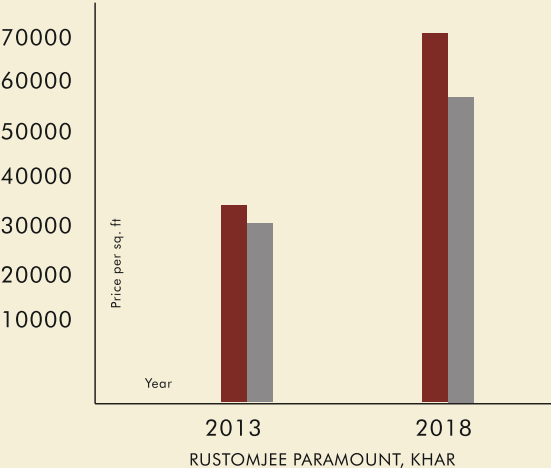

■ RUSTOMJEE RATE      ■ MICRO MARKET RATE



IT'S THOUGHTFUL. IT'S **Rustomjee**<sup>®</sup>

CALL: 6111 6111 | SMS: 'HOMES' TO 566778 | WWW.RUSTOMJEE.COM

SITE ADDRESS: RAJENDRA NAGAR, DATTAPADA ROAD, NEAR BORIVALI EAST-WEST FLYOVER,  
BORIVALI (E), MUMBAI-400 066.

CORPORATE OFFICE: 702 NATRAJ, M.V. ROAD JUNCTION, WESTERN EXPRESS HIGHWAY,  
ANDHERI (E), MUMBAI - 400 069.

---

Disclaimer: The plans, specifications, images and other details depicted herein are only indicative and the Promoter reserves the right to change any or all of these in the interest of the development as per applicable rules and regulations. It does not constitute an offer and/or contract of any type between the Promoter and the recipient. Any prospective sale shall be governed by the terms and conditions of the agreement for sale to be entered into between the parties and recipient shall refer the MahaRERA Project site for complete details. The property is mortgaged with ICICI Bank Limited. The No Objection certificate (NOC)/ permission of the mortgagee Bank/Security trustee would be provided for sale of flats/units/property, if required.



MahaRERA Registration No: P51800003590. Available on the website: <http://maharera.mahaonline.gov.in>.