



S A I R A H

EXTRAVAGANT, AFFLUENT, EXCELLENT



SAIRAH

EXTRAVAGANT, AFFLUENT, EXCELLENT

About Project



Extravagant - Sairah will be more than just a building made of concrete, brick and mortar, it is conceived to convey a far lasting impression. Sairah will be distinctive in characteristics - from location to space and aesthetics to being a symbol of pride and privilege.

Affluent - Here, the mornings begin with invigorating fresh air, the melodious chirping of birds and a cup of brew in a cozy apartment in serene surroundings. It gives you a gated community with like-minded family as neighbours.

Excellent - From connectivity to the outside world to connectivity with self, Sairah gives you ample reasons to cheer. Once ready, Sairah will be known for its superior quality well ahead of its time. A well planned structure with well thought out small details makes this a unique proposition.



Floor Plans

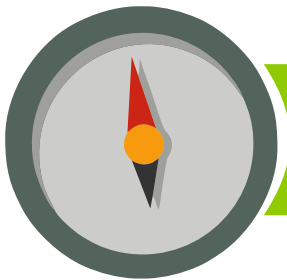
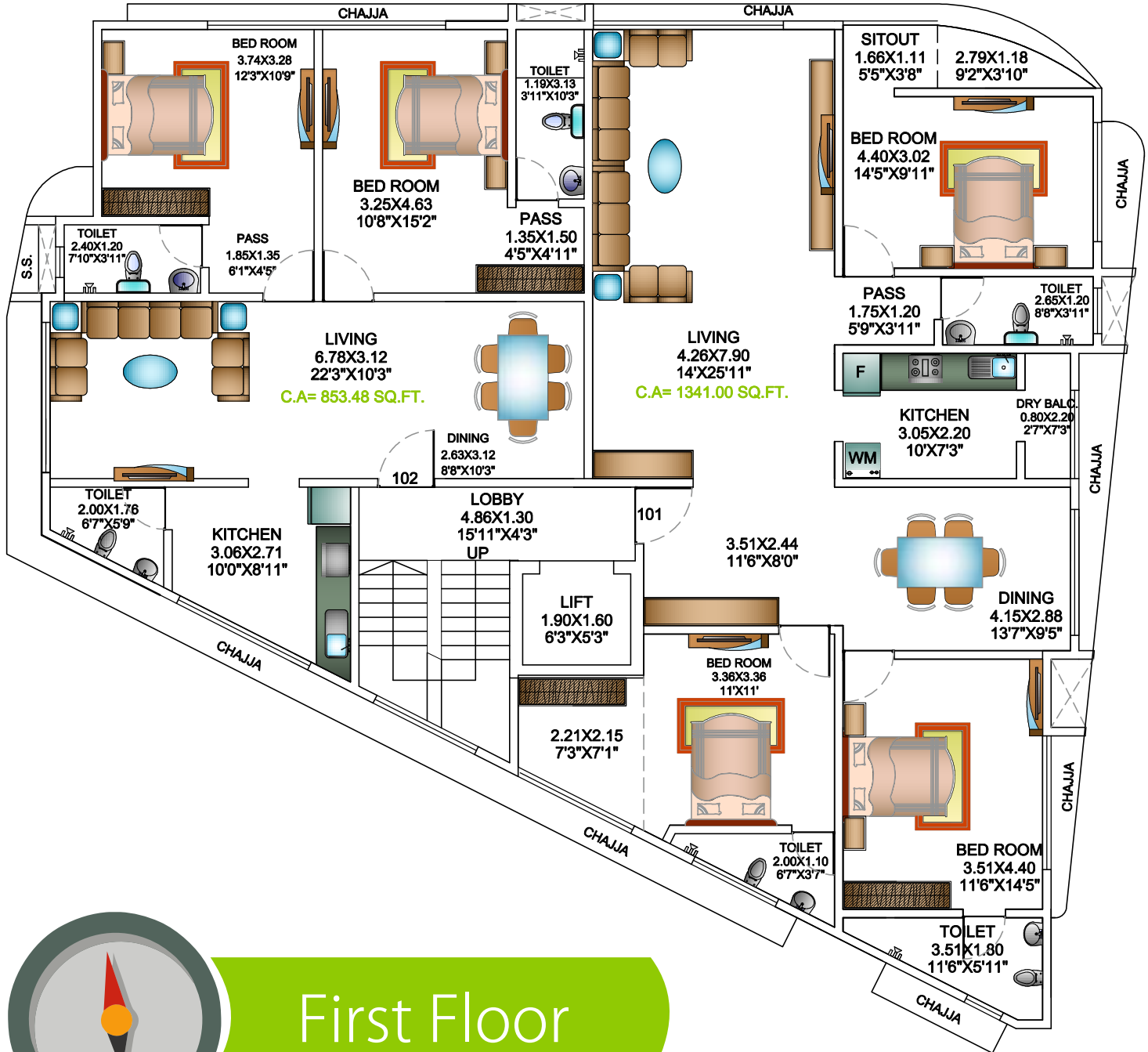

First Floor



Floor Plans

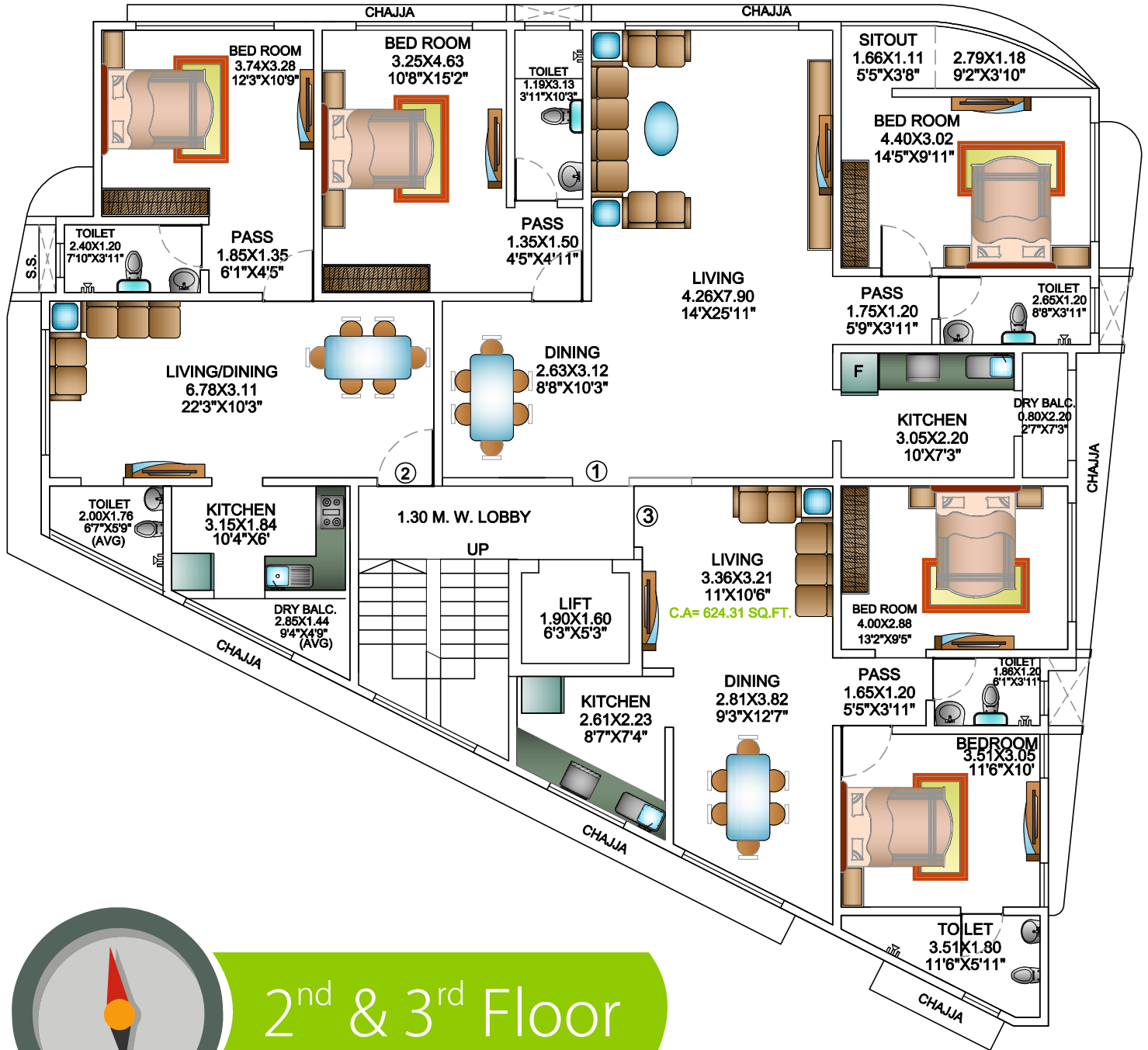

3d view of flats - 3 BHK



3d view of flats - 4 BHK



Located in the heart of the city



- ✦ Located on M. V. Pandloskar Marg, it is easily accessible from Western Express Highway & Vile Parle Railway Station
- ✦ Close proximity to Banks, Hospitals, Schools, Colleges, Post Office, Restaurants, Airports, Cinema Halls & other public utilities



Professionals

- ✦ **Architect:** Rasik P. Hingoo Associates, Goregaon (W)
- ✦ **R.C.C. Consultants:** K. C. Shah Consultants, Kandivali (W)
- ✦ **Solicitors:** Manoj & Ashok Associates, Wadala



About Us



We have this saying around our company: Greater Together. It's a testament to how much better we are when we work together.

We are known for our finishing act. Keeping a date with commitment is the core of Metro's ethos. Each project is a mission to fulfill your expectations. We respect and care about your stake and our reputation. We are passionate about setting new standards of delivery and customer contentment.



Amenities



- ✦ Earthquake Resistant Good Quality RCC construction
- ✦ Well ventilated apartments with ample natural light
- ✦ Rain Water Harvesting system
- ✦ Ample Car Parking Area
- ✦ External Wall finish with weather proof premium Acrylic paints of premium brand and approved colour
- ✦ Provision of modern security systems
- ✦ Good quality Miniature Circuit Breakers (MCB & ELCB)
- ✦ Modular switches of reputed brand
- ✦ Concealed plumbing of ISI approved quality pipes and fittings
- ✦ Quality Branded C.P & Sanitary fittings
- ✦ Granite platform with good quality Stainless Steel Sink



Disclaimer:

The information contained in the brochure is indicative of the kind of development that is proposed. It is prepared and issued for guidance only. It does not constitute part of an offer or contract subject to the approval of the authorities. In the interest of the continuing improvement the developer has right to change plans, specification or features without prior notice or obligation.



Office Address:

Metro Associates, Office # 10,
Triple S Heights, Jakeria Road,
Malad (W), Mumbai - 400 064

Site Address:

Sairah, Plot # 10, Shivaji Nagar
Colony, M. V. Pandloskar Marg,
Vile Parle (E), Mumbai - 400 057