

WELCOME TO
A LARGER THAN LIFE EXPERIENCE
AT KHANDESHWAR, NAVI MUMBAI



SILVERCREST

KHANDESHWAR, NAVI MUMBAI.

1 & 2 BHK Plush Residences



ARTIST'S IMPRESSION

PODIUM - FIRST FLOOR PLAN



- | | | | |
|-----------------------|----------------------------|-----------------------------|-----------------------------|
| 01. Entry Stairs | 05. Games Room | 09. Jogging / Walking Track | 13. Senior Citizen Sit outs |
| 02. Washroom | 06. Entrance Plaza / Stage | 10. Meditation Area | |
| 03. Gymnasium | 07. Mutipurpose Lawn | 11. Kid's Play Area | |
| 04. Multipurpose Hall | 08. Amphitheatre Seating | 12. Mutipurpose Court | |

PODIUM FEATURES

- Landscaped Podium Garden
- Jogging Track
- Health Club
 - Gym- Multipurpose hall
 - Indoor Games Area
- Party Lawn
- Outdoor Kid's Play Area
- Multipurpose Court
- Sit Outs
- Senior Citizen Corner

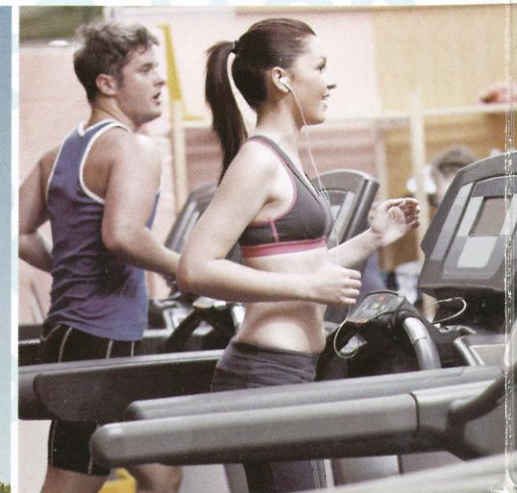

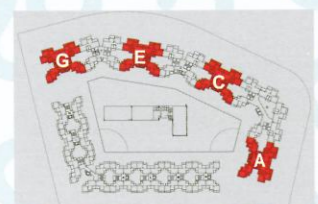

A, C, E & G WING
ODD FLOOR PLAN

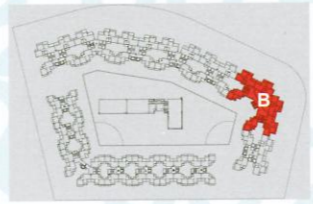

B WING ODD FLOOR PLAN

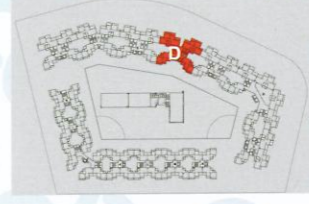

D WING ODD FLOOR PLAN

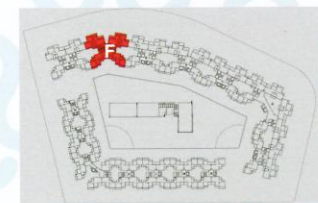

F WING ODD FLOOR PLAN

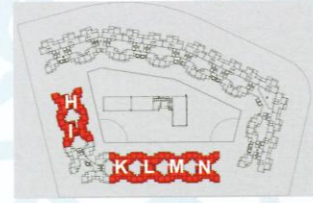

H, I, K, L, M & N WING
ODD FLOOR PLAN



J WING ODD FLOOR PLAN





AN OUTSTANDING LIFE IN KHANDESHWAR, NAVI MUMBAI

The Project

Welcome to this one-of-its-kind landmark project of Khandeshwar, Navi Mumbai featuring lavish 1 & 2 BHK residences with ultra-modern lifestyle amenities and facilities. Located at the serene and one of the fastest developing nodes of Navi Mumbai, Silvercrest not only offers tranquil environs to dwell but also provides great connectivity across the city. With superb locality and a superior-class living, Silvercrest sets your life absolutely class-apart.

- G+6 & G+14 Storey Buildings
- A Complex of 14 Buildings
- 1 & 2 BHK Plush Residences
- Power Back-up for Lifts and Common Areas
- 24x7 Security and Surveillance System



LOCATION MAP



Location Advantages:

- Proposed International Airport in close vicinity
- Close Vicinity to Mumbai-Pune Highway
- Opposite to Khandeshwar Railway Station
- Mansarovar Railway Station in the vicinity
- MGM Hospital in close vicinity
- Tata Hospital in close vicinity
- Close proximity to Central Park
- International Standard Golf Corse
- ISKCON Temple
- Schools, colleges & shopping centers in close vicinity



GEOMATRIX

GEOMATRIX DEVELOPERS LLP

Site Office: Silvercrest, Plot No. 29, Sector 25, Opp. Khandeshwar Rly. Stn., Kamothe II, Navi Mumbai.

Call: 90763 33666 / 76666 88788 • Email: geomatrixdevelopers@yahoo.in

Disclaimer : The developers shall have absolute right and authority to decide the manufacturer / make / size / colour / variant of all the above amenities without having any reference or recourse. The intent purchasers shall not object to any selection so made by the developers.