

WELCOME
TO THE
AREA-CODE
OF THE
ULTIMATE
RESIDENTIAL
BLISS!



Site Address: Dosti Oro 67, Near Mayura Jewellers, Sambath Estate, Bandar Pakhdi Road, Kandivali (W), Mumbai - 400 067

Corporate Office: Dosti Realty Ltd., Lawrence & Mayo House, 1st Floor, 276, Dr. D. N. Road, Fort, Mumbai - 400 001.

W: www.dostirealty.com | T.: +91 22 2219 8500

Architect Parin Shah
Design Architect

SACPL
RCC Consultants

Mak MEP Consultants
Mep Consultants

M/s. Skytech Consultants
Liasioning Architect

Vigil Juries
Solicitors

Lerch Bates PVT. LTD.
Vertical Transport Consultant

The projects has been registered via MAHARERA registration number: 00000000000 and is available on website - <https://maharera.mahaonline.gov.in> under registered projects.

Disclosures: (1) The artist's impressions and stock images are used for representation purpose only. (2) Furniture, fittings and fixtures as shown/displayed in the show flat are for the purpose of showcasing only and do not form part of actual standard amenities to be provided in the flat. The flats offered for sale are unfurnished and all the amenities proposed to be provided in the flat shall be incorporated in the Agreement for Sale. (3) The right to admission, use and enjoyment of all or any of the facilities/amenities in the Clubhouse of the Dosti Oro 67 Project is reserved by the Promoters and shall be subject to payment of such admission fees, annual charges and compliance of terms and conditions as may be specified from time to time by the Promoters. (4) The sale of all the premises in the Dosti Oro 67 project shall be governed by terms and conditions incorporated in the Agreement for Sale.

WHERE
THE CITY
REVOLVES
AROUND
YOU...

Your home makes you the center-piece of all its advancements,
your life sets new benchmarks in residential luxury standards

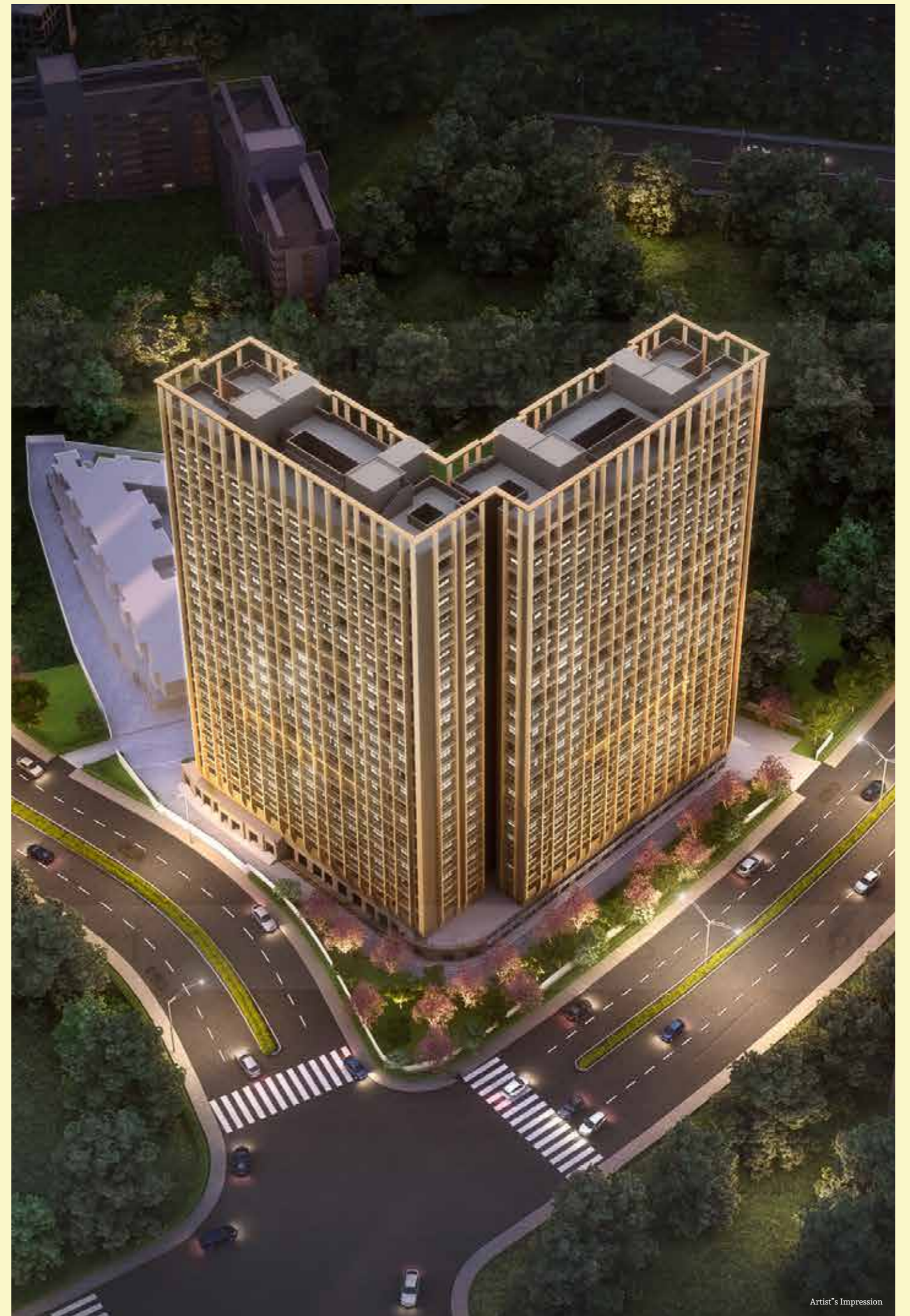



Artist's Impression

DUMMY IMAGE USED. WAITING FOR DRONE SHOT.



Artist's Impression

Presenting...



DOSTI
ORO 67

IT'S THE PERFECT PLACE
TO CALL HOME!

Welcome to a paradise you can call home, that enchanted with
the luxuries of tomorrow while keeping you well-connected
and comfortable with the advancements of today.

















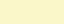



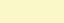
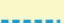
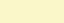
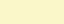

KANDIVALI, MUMBAI'S NEWEST RESIDENTIAL HOTSPOT

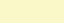
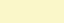
Welcome to the newest area-code of superior housing, and to its most forthcoming landmark, Dosti Oro 67. The prime locale of Kandivali offers its residents everything one can wish for, from the traditional wants of temples, the likes of nature lovers to the new-gen needs of shopping malls and commercial parks. In the recent times, Kandivali has proven to be the top choice of families across the city boundaries, owing to fast connectivity, proximity to open natural places and as it's most sought-after place for new developments.

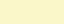
HIGH-SPEED LIVING FROM THE CORE OF CONNECTIVITY

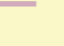
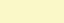
Kandivali Station	3.5 km	12 mins
Malad Mindspace	4.3 km	17 mins
Western Express Highway	5.2 km	18 mins
Andheri SEEPZ	15.9 km	40 mins
Domestic Airport	17.3 km	55 mins
Chhatrapati Shivaji Maharaj International Airport	17.5 km	55 mins
Powai	18.0 km	1 hr
BKC	22.9 Km	1 hr, 10 mins
Thane	28.7 km	1 hr 13 mins
Dadar	29.5 km	1 hr 15 mins
Bandra-Worli Sea Link	31.3 km	1 hr 20 mins
Fort	38.6 km	1 hr 28 mins
Nariman Point	41.5 km	1 hr 40 mins

-  Airport
-  Eastern Express Highway
-  Western Express Highway
-  Ghodbunder Road
-  Chembur - Jacob Circle Monorail Line
-  Santacruz - Chembur Link Road
-  Eastern Freeway
-  Bandra - Worli Sea Link
-  Business Hub
-  Ghatkopar - Versova Metro Line 1
-  Western Railway
-  Central Railway
-  Harbour Railway
-  Ferry Wharf Jetty
- UNDER CONSTRUCTION INFRASTRUCTURE**
-  DN Nagar - Dahisar Metro Line 2A
-  DN Nagar - Bandra - Mandale Metro Line 2B
-  Colaba - Bandra - Seepz Metro Line 3
-  Wadala - Ghatkopar - Thane Metro Line 4
-  Thane - Bhiwandi - Kalyan Metro Line 5
-  Swami Samarth Nagar - Jogeshwari Vikhroli
-  Metro Line 6
-  Andheri (E) - Dahisar (E) Metro Line 7
-  Dahisar (E) - Mira Bhayandar Metro Line 7A
-  CSIA - Navi Mumbai International Airport Metro Line 8
-  Dahisar (E) - Mira Bhayandar Metro Line 9
-  Wadala - GPO (CST) Metro Line 11
-  Mumbai Coastal Road
-  Mumbai Trans Harbour Link (Sewri - Nhava Sheva)
-  Navi Mumbai International Airport
-  Thane Water Ways Transport Along Ulhas River (Thane to Vasai, Kalyan & Bhiwandi)
- Proposed Infrastructure**
-  Thane - Borivali Tunnel
-  Virar - Alibaug Multi-modal transport Corridor
-  Thane - Dombivli Flyover
-  Metro Line 10 Gaimukh (Ghodbunder) - Shivaji Chowk (Mira Road)
-  Metro Line 12 Kalyan - Taloja
-  Kolshet Jetty
-  Bandra Versova Sea Link
-  Coastal Road from Kandivali to Ghodbunder Road
-  Worli to Sewri connector



Source: Google Maps. Not to Scale
 *All proposed infrastructures mentioned are as per what is shown on MMRDA website as on 25th November, 2020 & Article: <https://indianexpress.com/article/cities/mumbai/coastal-road-will-be-extended-to-ghodbunder-from-bandra-versova-sea-link-5156559/>

SCHOOLS

RAIS International Business School & Junior College - BBA, Andheri West, Mumbai	1.1 km	04 mins
PJ Pancholia High School	1.2 km	05 mins
St Josephs High School	1.3 km	06 mins
Thakur International School (IGCSE and A-Levels)	1.3 km	06 mins
Oxford Public School	1.6 km	07 mins
Kapol Vidyanidhi International School	1.7 km	07 mins
Bal Bharati College of Commerce	3.0 km	12 mins
Orchids Internations	3.0 km	14 mins
Ryan International School	4.0 km	17 mins
St. Lawrence High School	4.1 km	17 mins
Cambridge School - ICSE	6.1 km	22 mins

LIFE AND COMFORT
GO HAND-IN-HAND,
WHEN WELL-CENTERED

COLLEGES

Oxford B.E.D College	1.7 km	7 mins
Kapol Vidya Niddhi College of Hotel Management	1.7 km	7 mins
Nirmal College	2.2 km	8 mins
KES Shri Jaintilal Patil Law College	2.9 km	10 min
Prakash College of Commerce and Science	2.9 km	11 mins
Thakur College of Engineering	6.9 km	20 mins
Thakur College of Arts and Science	8.3 km	25 mins

HOSPITALS

Shakuntala Bhatia Maternity and General Hospital	900 m	04 mins
Lotus Multispeciality Hospital	1.2 km	04 mins
Mangal Murti Hospital	1.3 km	06 mins
Omkar Hospital	1.3 km	06 mins
Chavan Hospital	1.5 km	07 mins
Phoenix Hospital	1.6 km	06 mins
United Multispeciality Hospital	1.7 km	06 mins
Surana Hospital and Research Centre	3.2 km	15 mins
Zenith Multispeciality Hospital	2.4 km	14 mins

ENTERTAINMENT, MALLS & MARKETS

Raguleela Mall	2.7 km	10 mins
Mayura cinema	2.9 km	10 mins
Kandivali Recreation Club	3.0 km	10 mins
Bachi Resort	3.9 km	12 mins
PVR	4 km	20 mins
Carnival Cinemas	5.2 km	20 mins
Inorbit Mall	5.3 km	22 mins
Hyper City	5.5 km	20 mins
Centrium Mall	7.3 km	20 mins
Oberoi Mall	8.8 km	20 mins
The Hub Mall	10.9 km	20 mins

WORSHIP

Holy Cross Chapel	280 m	1 min
Hanuman Temple	800 m	3 mins
Ambe Mata Temple	1.0 km	3 mins
Datta Temple	1.0 km	3 mins
Pawan Dham Temple	1.1 km	4 mins
Omkareshwar Mandir	1.1 km	5 mins
Iskcon Temple	1.8 km	6 mins
Sai Baba Mandir	2.7 km	8 mins

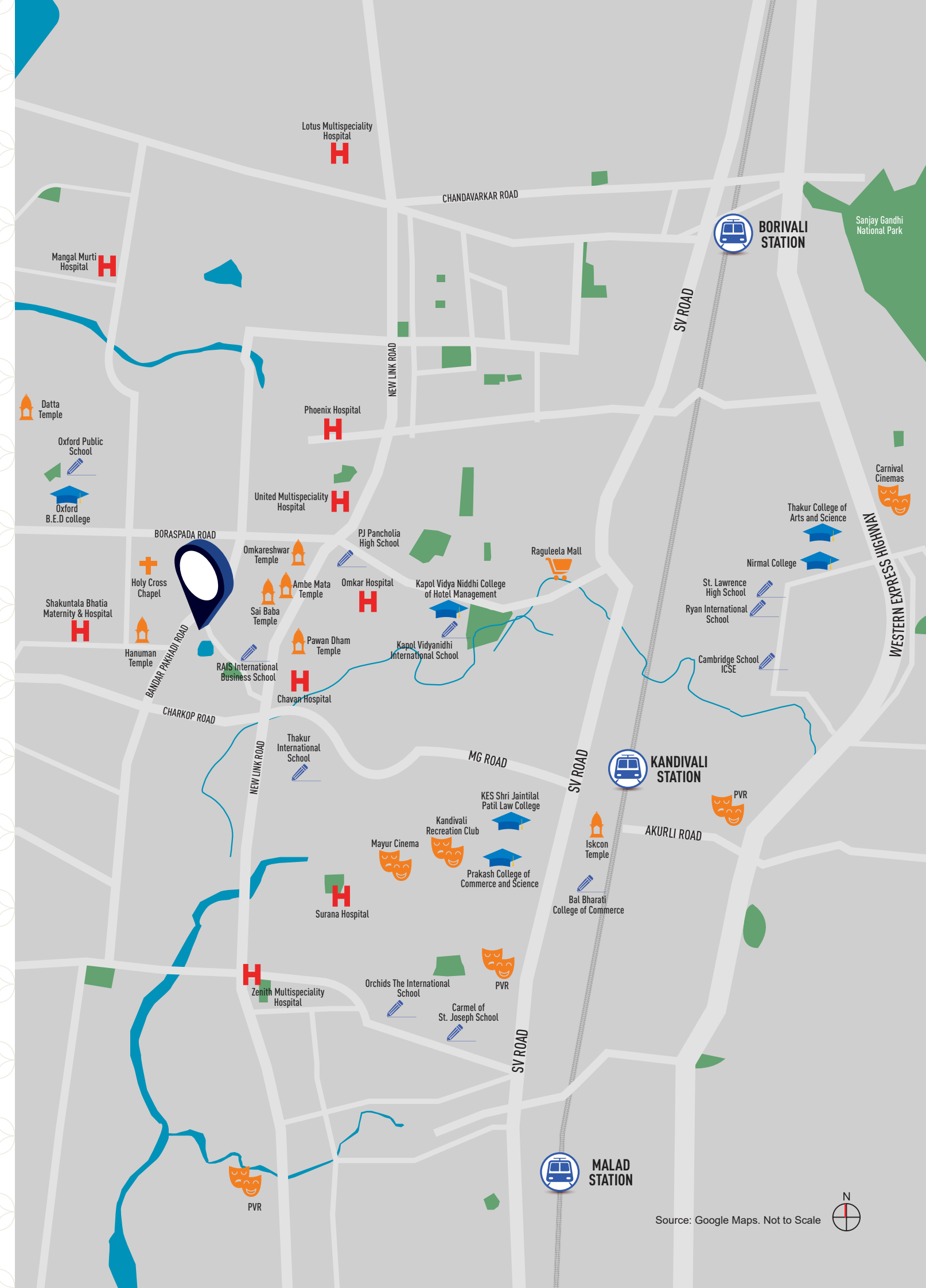



Stock image used for representation purpose only

WHERE
AMENITIES
ARE DEDICATED
TO YOUR
LEISURE,
LIFE
BECOMES
BLISSFUL!

LUXURIES
OF THE
MODERN DAY
ACQUIRED
FOR THE
EASE OF
EVERYDAY!



KIDS' PLAY AREA

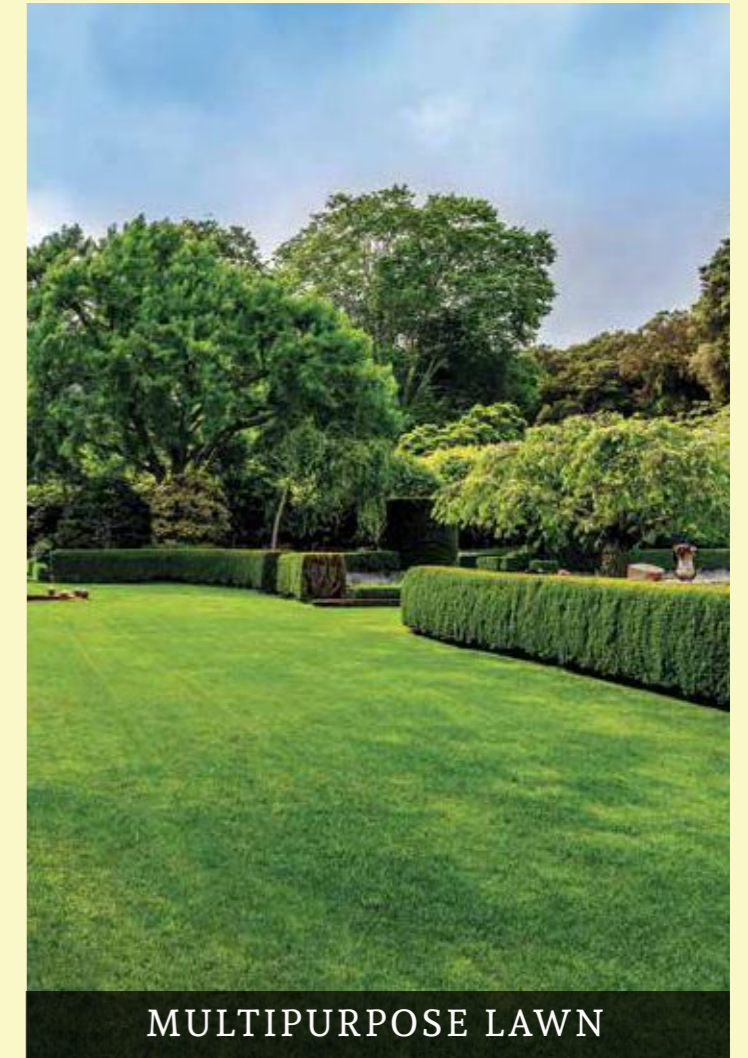

MULTIPURPOSE LAWN



SWIMMING POOL



CLUB HOUSE - LAWN VIEW

Artist's Impression



STAR GAZING ZONE



BANQUET HALL



YOGA / MEDITATION ZONE



GYMNASIUM



GARDEN

Stock image used for representation purpose only



AN AREA
CRAFTED TO
PERFECT
THE TERM
'RESIDENTIAL
LIVING'



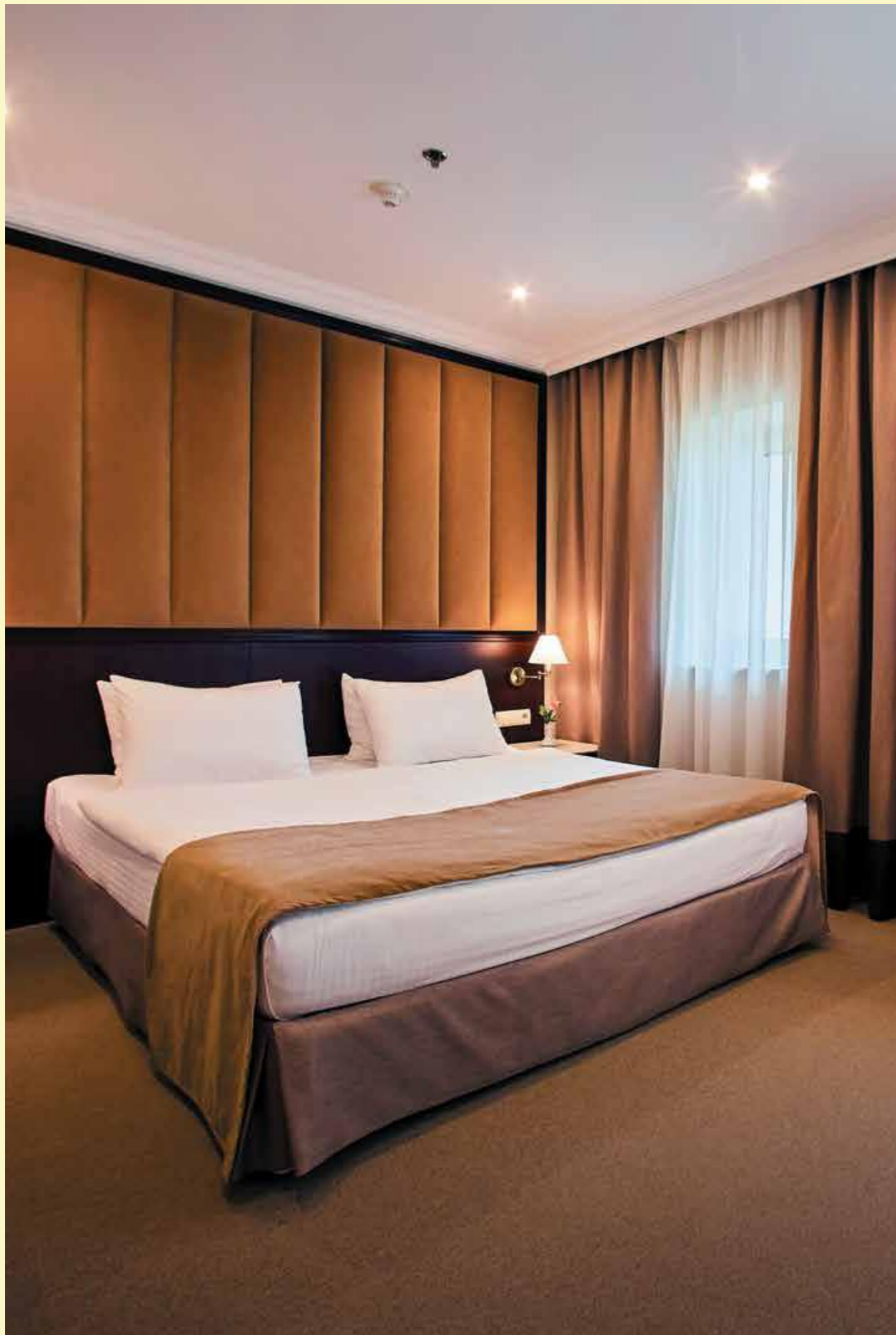

Stock image used for representation purpose only

INTERNAL SPECIFICATIONS

> FLOORING

- Vitrified flooring in living/dining, bedroom, kitchen and passage

> KITCHEN

- Desert brown Quartz stone for kitchen platform with marble support
- Stainless steel sink with drain board of reputed make
- Tile dado of reputed make

> ELECTRICAL

- Electrical wiring & fitting of concealed type P.V.C conduit
- All switches of reputed make one ELCB per flat and MCB for each room
- TV, AC point, ceiling fan point and regulator point in living, bedroom
- WIFI point provision, telephone point in living room & all bedrooms

> DOORS

- Flushed Doors in living, bedrooms with laminate finish

> WINDOWS

- Sliding windows with engineered frames with clear glass
- M.S. decorated grills for living, bedrooms and kitchen windows
- Mosquito net for bedroom and living room

> PAINTING

- Gypsum finish internal walls
- Premium eco friendly quality paint for walls & ceilings

> STATE-OF-THE-ART CP AND SANITARY FITTINGS

- Matt finish tiles for all toilets flooring
- All toilets with dado tiles
- 15 Ltrs boiler with hot-cold mixer in toilets
- Toilet doors with laminate finish
- Well ventilated bathrooms
- Mirror above counter wash basin
- False ceiling in toilets

> SECURITY

- Central intercom system with CCTV & video doorphone
- 24 hours gated security
- Security access control at podium & main entrance lobby
- Provision of access control cards for residents
- Fire fighting & fire alarm system for entire building
- Fire sprinkler in each apartment, lobbies & podiums
- High speed fireman's evacuation elevator of reputed make
- High speed passenger elevators of reputed make



SPACIOUS
HOMES
DESIGNED
TO FIT
EVERY
HOUSING
DREAM

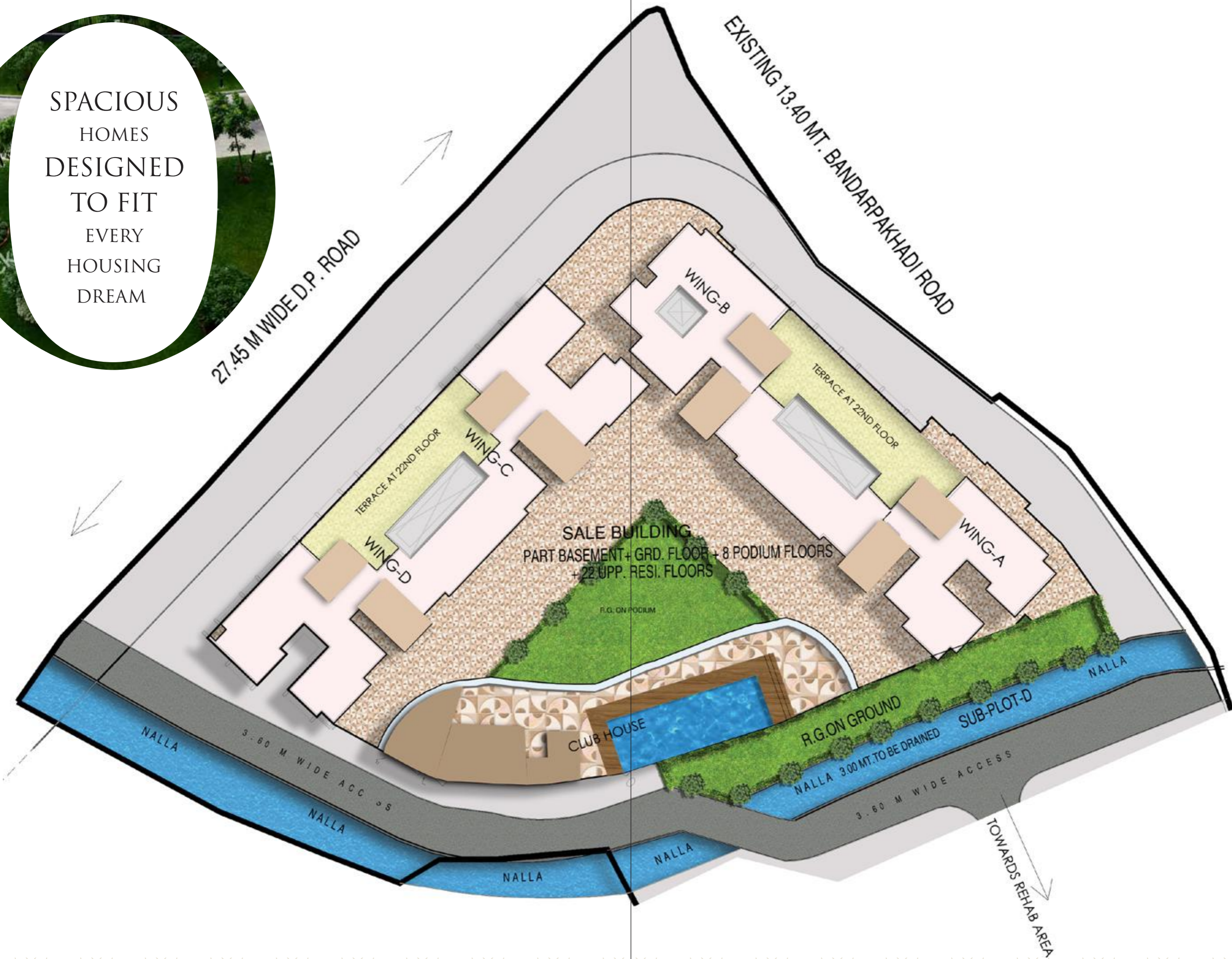

Typical Floor Plan
Wing - A, B, C, D
8th to 13 Floors &
15th to 21st Floors

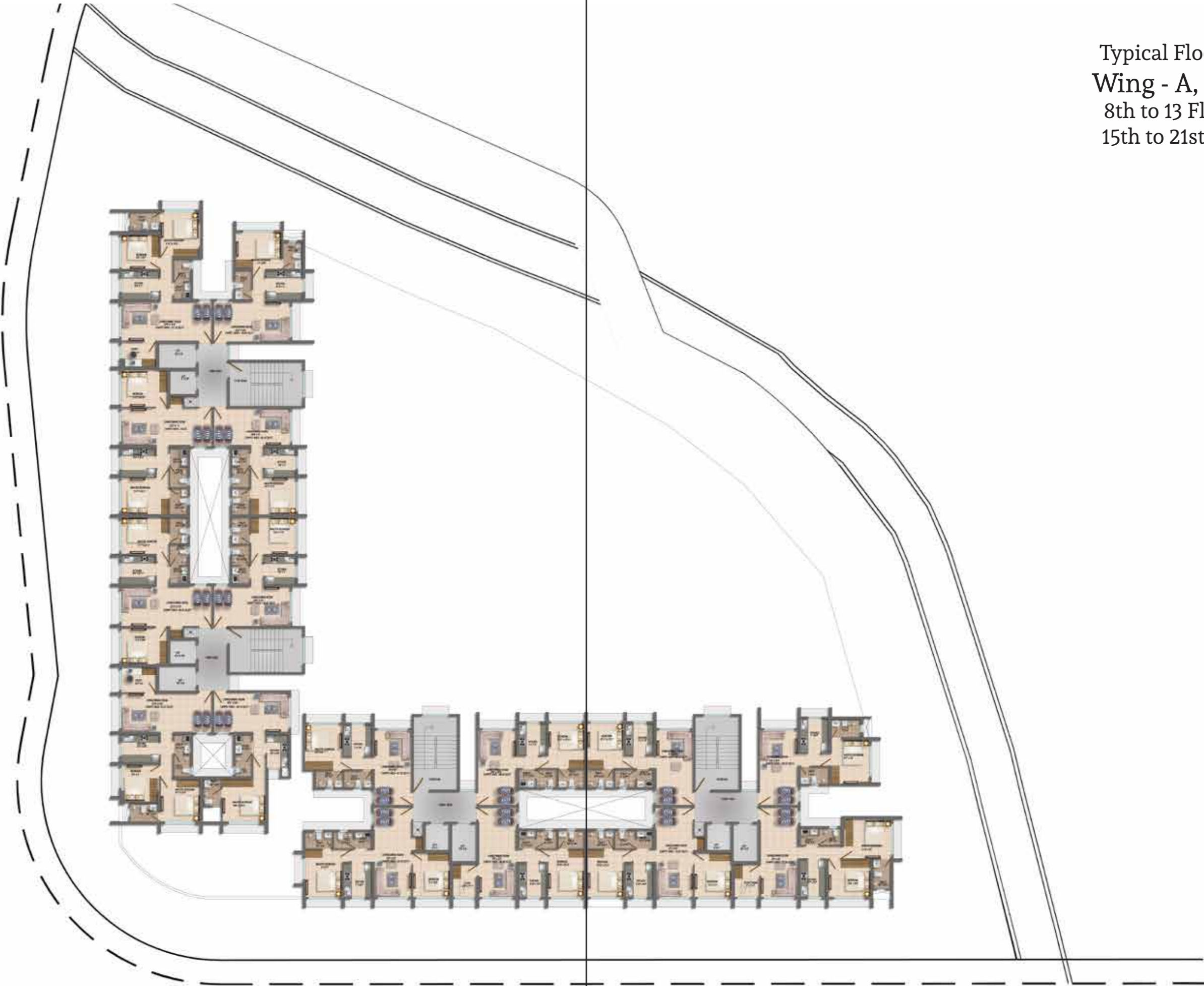

A1 - FLAT NO. 1
 1 BHK (Type 1)
 RERA CARPET: 435.83 SQ. FT.

Areas	Size

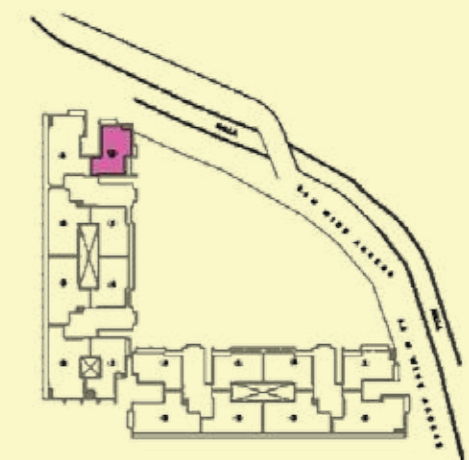

Please Note: All dimensions of carpet area are from unfinished wall surface. Minor variations/ tolerance of +/- 3% in carpet area may occur on account of design and/or construction exigencies. All dimensions are in meters. Conversion: 1 sq. mt. = 10.764 sq. ft. *Conversion in square feet for convenience purpose & easy understanding.



B3 - FLAT NO. 3
2 BHK (TYPE 1) WING - B
RERA CARPET: 607.50 SQ. FT.

Areas	Size



Please Note: All dimensions of carpet area are from unfinished wall surface. Minor variations/ tolerance of +/- 3% in carpet area may occur on account of design and/or construction exigencies. All dimensions are in meters. Conversion: 1 sq. mt. = 10.764 sq. ft. *Conversion in square feet for convenience purpose & easy understanding.



D3 - FLAT NO. 3
2 BHK (Type 2) - WING - D
RERA CARPET: 586.53 SQ. FT.

Areas	Size

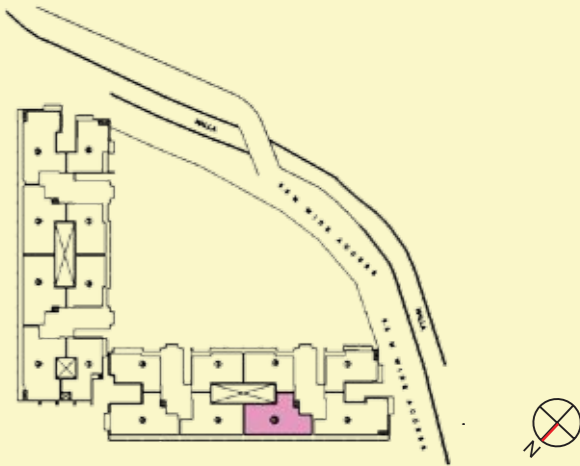

Please Note: All dimensions of carpet area are from unfinished wall surface. Minor variations/ tolerance of +/- 3% in carpet area may occur on account of design and/or construction exigencies. All dimensions are in meters. Conversion: 1 sq. mt. = 10.764 sq. ft. *Conversion in square feet for convenience purpose & easy understanding.

GREEN FEATURES

Water Efficient Fixtures to Reduce Water Consumption



Electricity and Power Backup for Common Areas



Energy Efficient Lights in Common Areas



EV Charging Station for Electrical Car Charging



Solar Panels for Hot Water



BMS (Building Maintenance System)



Rain Water Harvesting



Sewage Treatment Plant



Organic Waste Composter



DISCOVER YOUR FRIENDS FOR LIFE

Dosti Realty has been in the real estate business for over 3 decades and delivered more than 117 properties till date, providing homes to over 8,600+ families for over 42,700 residents. Encompassing a portfolio of having delivered 10 mn. sq. ft. and currently constructing around 6 mn. sq. ft. across Mumbai and Thane, the company has experience in various development types, be it Residential, Retail, IT Parks, etc. Over the years, it has been known for Aesthetics, Innovation, Quality, Timely Delivery, Trust and Transparency; core values that have built lasting relationships.

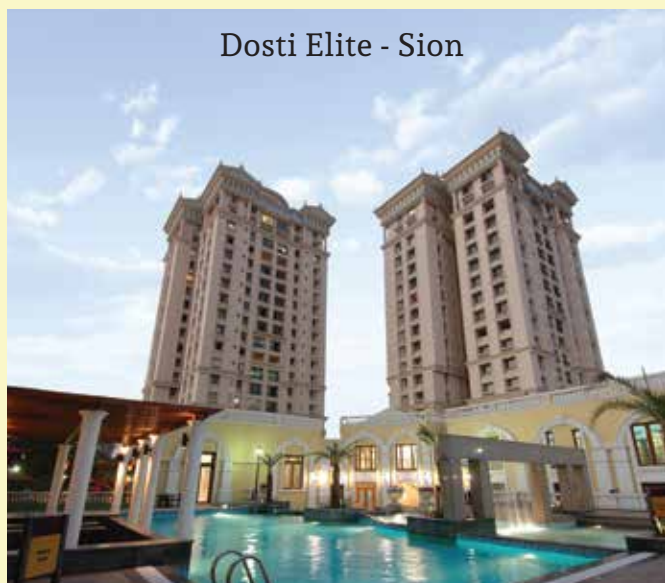
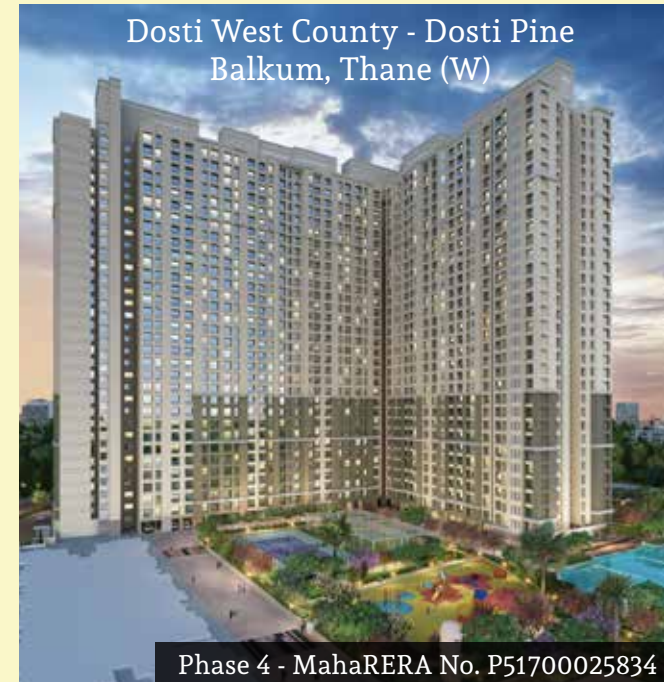
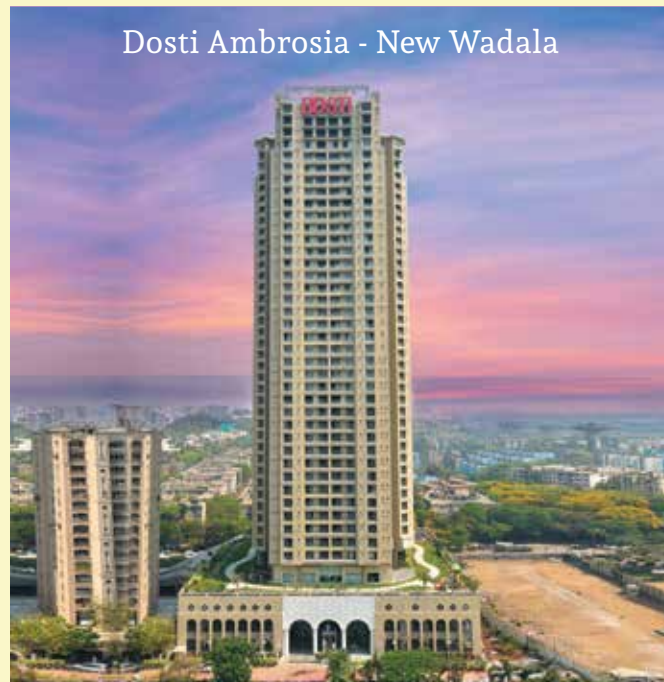
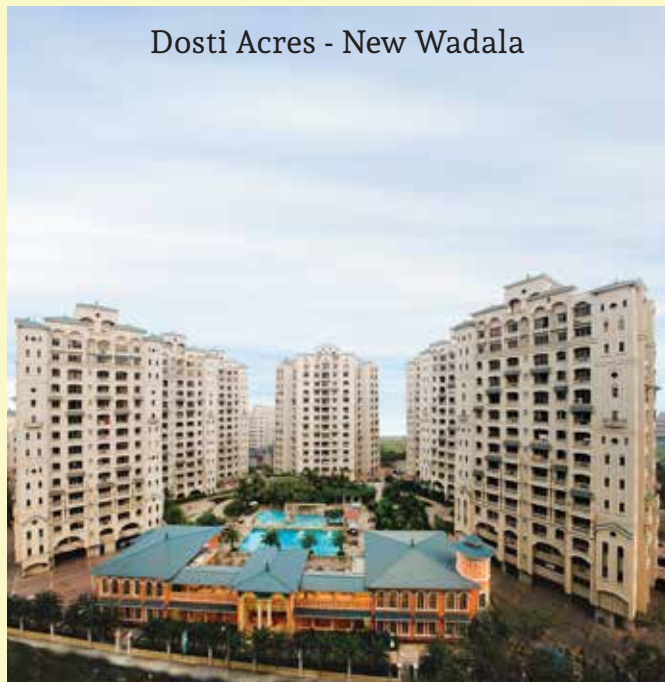

All Images are Actual

All Images are Artist's Impression



A RICH RECORD OF OUR ESTEEMED AWARDS & GRAND ACHIEVEMENTS

- Dosti Eastern Bay - New Wadala won Iconic Luxury Homes - South Mumbai by Mid Day Real Estate Icons Awards 2020
- Dosti Realty awarded Developer of the Year (Residential) at the Real Estate Business Excellence Awards, 2020 in association with CNN-News 18.
- Dosti West County Iconic Planned Project Central Mumbai 2019 - Mid-day Real Estate Icons Awards 2019
- Dosti West County awarded Iconic Planned Project Central Mumbai 2019 by Mid-Day Real Estate & Infrastructure Icons Award 2019
- Dosti West County awarded Best Project of the Year Thane in 2018 by Accommodation Times
- Dosti West County Awarded Ultimate Residential project Thane in 2018 by Hindustan Times
- Dosti Desire Awarded Residential project of the Year Thane in 2018 by Accommodation Times
- Dosti Realty Ltd. Awarded Excellence in Quality Residential Projects by Lokmat Corporate Excellence Awards 2018
- Dosti Realty Ltd. Awarded Best Developer Residential by ET Now in 2018
- Dosti Realty Ltd. Awarded Best Green Building for Dosti Ambrosia - New Wadala by ET Now in 2018
- Dosti Realty Ltd. was awarded Real Estate Industry Achievement Award - 2017 Grohe Hurun
- Dosti Desire has been awarded the Iconic Residential Project, Thane - Mid-Day Real Estate Icons in 2017
- Dosti Realty Ltd. Awarded Iconic Developer Thane by Mid-Day Real Estate Icons (Thane & Navi Mumbai) in 2017
- Dosti Planet North, Shil Thane - Awarded Iconic Residential Project Beyond Thane, Mid-Day Real Estate Icons (Thane & Navi Mumbai) in 2017
- Dosti Planet North, Shil Thane - Certified as Times Realty Icons 2017 Navi Mumbai, Thane & Beyond, in the category of Value Homes (Thane & Beyond) in 2017
- Dosti Majesta, Ghodbunder Road, Thane (W) - Certified as Times Realty Icons 2017 Navi Mumbai, Thane & Beyond, in the category of Ultra Luxury Homes (Thane & Beyond) in 2017
- Dosti Ambrosia, New Wadala - Project of the Year Mumbai at the 31st National Real Estate Awards by Accommodation Times in 2017
- Dosti Ambrosia, New Wadala awarded Iconic Residential Project - South Mumbai at the Mid-Day Real Estate Icons Awards in 2016
- Dosti Ambrosia, New Wadala Certified Gold Rating under IGBC for Green Building by LEED in 2016
- Dosti Acres, New Wadala awarded 2nd place at the Exhibition for Gardening at the Veermata Jeejabai Bhosle Garden, Byculla by the Tree Authority and Brihan Mumbai Mahanagarpalika in 2015
- Dosti Ambrosia, New Wadala was awarded Best Residential Project of the Year by Construction Times in 2015
- Dosti Vihar, Thane won the Premium Apartment Project of the Year (West) by NDTV in 2015
- Dosti Realty Ltd. was ranked Mumbai's Top Developer and the Best in Indian Real Estate for on-time delivery and possession by NDTV in 2014
- Dosti Vihar, Thane was awarded Project of the Year by Accommodation Times in 2014
- Dosti Imperia, Thane is pre-certified Green Building aiming for Gold rating by LEED in 2013
- Dosti Vihar, Thane won the title of an Artist in Concrete Awards for Space Planning in Big Residential projects by REIFY Artisans & Projects Pvt. Ltd. in 2013
- Dosti Realty Ltd. became an OHSAS 18001: 2007 (in 2018) & ISO 9001:2008 (in 2012) Certified Company by URS
- Dosti Acres, New Wadala won the Best Maintained Podium Garden by the Municipal corporation of Mumbai for consecutive years from 2008 onwards
- Dosti Elite, Sion won the 3rd prize for display of class 27-B at the 13th Exhibition for plants, flowers, fruits & vegetables by Municipal Corporation of Mumbai in 2008
- Dosti Elite, Sion has also been awarded the Best Maintained Podium Garden for 3 consecutive years
- Dosti Flamingos, Parel-Sewree won the Best Maintained Landscaped Garden by the Municipal Corporation of Mumbai in 2005