



**THE CLASSIQUE**  
STATUS. GRANDUR. VAASTU.

A Project By



**Add :** The Classique, Survey No.58, Hissa No.12, Near Green Park Society, P&T Colony, Gandhinagar, Manpada Road, Dombivli (East) - 421201

**Email :** sales@theclassique.in | **Web :** www.theclassique.in



Maha RERA Registration  
No. **P51700019813**

available on : [www.maharera.it.mahaonline.gov.in](http://www.maharera.it.mahaonline.gov.in)

**S 7666 573 573**

Future icon - Kharghar | 84199 41177

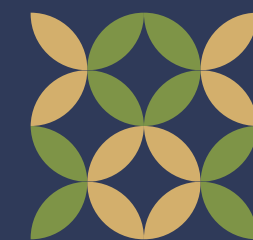

**THE CLASSIQUE**

WHERE CONVENIENCE MEETS LUXURY

Designing Architect



Liasoning Architect

**G N GANDHE**



RCC Consultants  
J W Consultants LLP



Advocate  
Sonia A Parkhi

# A WORLD OF UNCOMMON LIFESTYLE MADE COMMON FOR YOU

Thoughtful spaces. Luxury lifestyle. Excellent connectivity.

Extraordinary recreation & wellness. All of it coming together to create an uncommon lifestyle.

Experience a prominent lifestyle address of Dombivli that addresses your common needs, desires and aspirations and makes it very uncommon & unique through its amenities & facilities.

Welcome to an uncommon life. Welcome to The Classique Serenity.

- Tallest Tower in Dombivli City
- Stylist 1 & 2 BHK Apartments with Master Bedroom & sundeck
- Located in Heart of the city
- At the Center of Optimal Proximity

Present DCR Policy - 18 Floor  
Draft DCR Policy - 22 Floor



CLUB HOUSE



GYMNASIUM



ROOF TOP AMENITIES



CHILDREN'S PLAY AREA



CCTV SURVEILLANCE



SENIOR CITIZEN AREA





**1BHK ISOMETRIC VIEW**

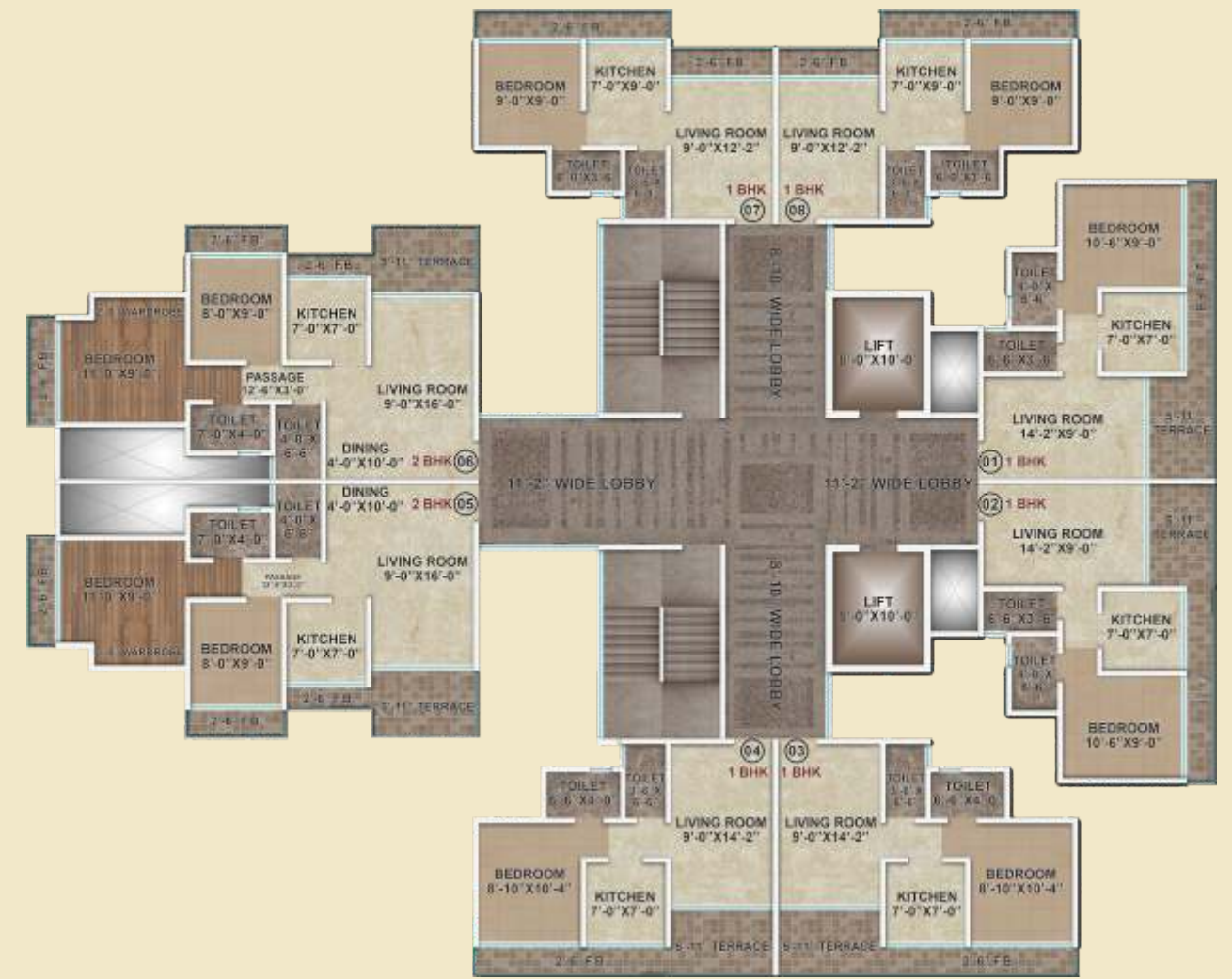

**EVEN FLOOR PLAN**



**2BHK ISOMETRIC VIEW**

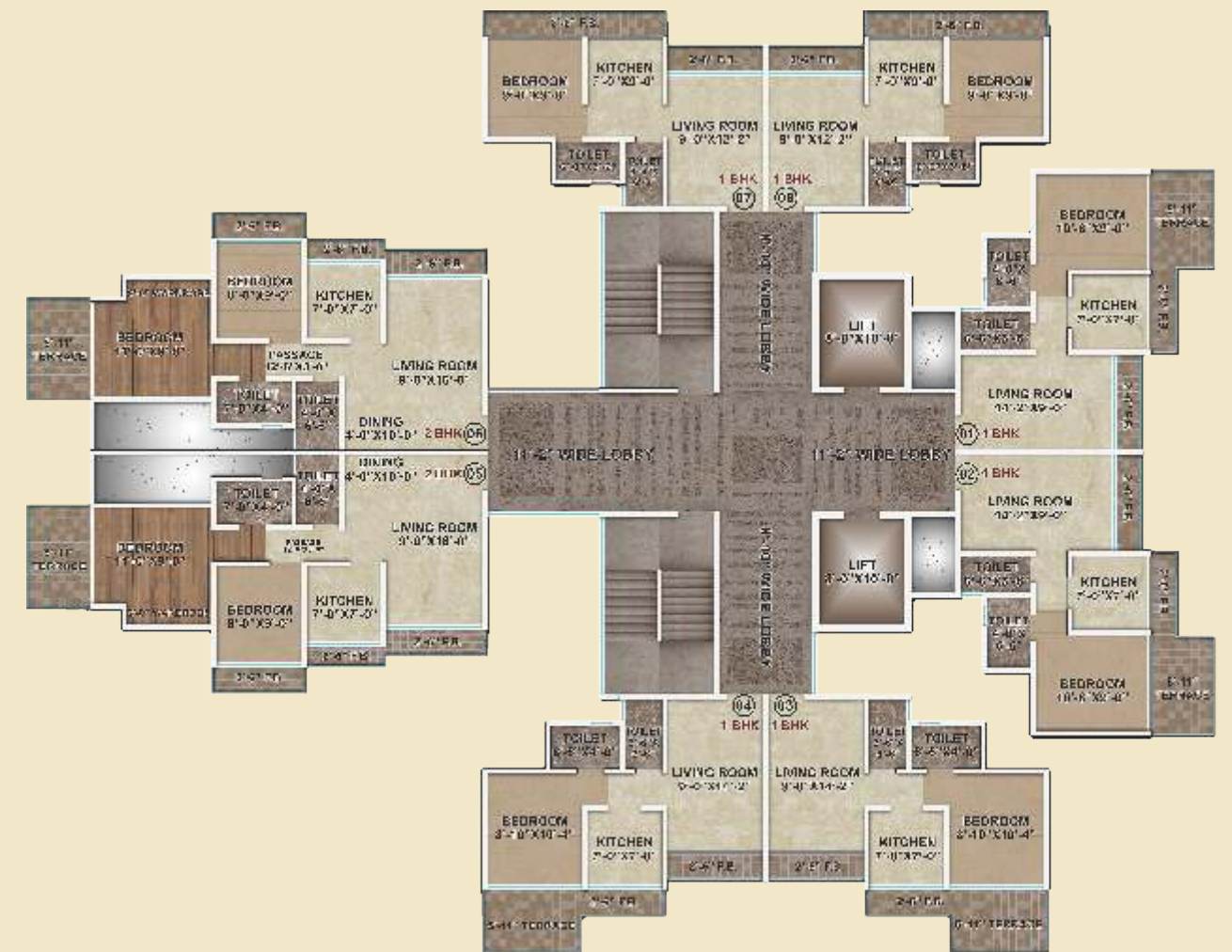

**ODD FLOOR PLAN**

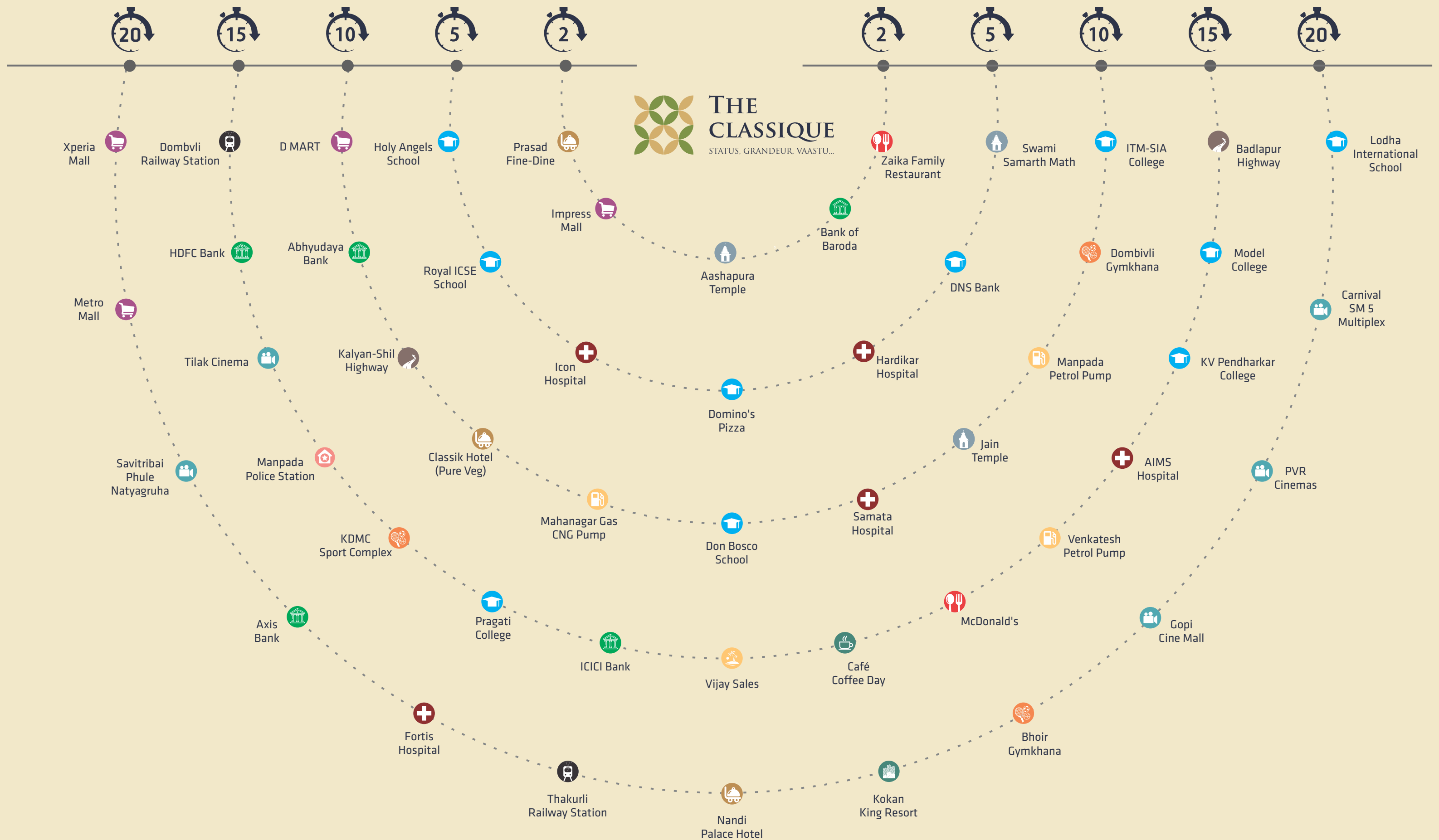

## EXCELLENT CONNECTIVITY AND CONVENIENCES MAKING LOCATION UNCOMMON

In the cosmopolitan like Dombivli, where everything is compact and located far from the desired needs, The Classique is an exclusive address bestowed with excellent connectivity. Situated in the heart of Dombivli, the prominent location of Dombivli with major schools, colleges, malls, multiplexes, banks, hospitals nearby, The Classique is truly a world of conveniences for you. Live here and experience the world coming to you at your doorsteps.

## ROOFTOP CLUB HOUSE



We create the way...  
for your **Dreams...**



artist's impression

A LIFE OF RELAXATION AND LEISURE  
**WHERE EACH MOMENT  
WILL BE  
FULL OF PLEASURE!**

## Internal Amenities

### Living Room

Marbo Granite or equivalent marble flooring in the living room Et passage area

- P.O.P. on walls with decorative cornice on the ceiling
- Heavy gauge sliding windows with mosquito screens
- Adequate points for television, Music system and telephone
- All walls will be painted with luster paint
- Lights Et Fan points
- Modular Switches of anchor or equivalent make
- Locks of reputed make
- S.S. and glass railing for flower beds.
- Magnetic Door Stoppers
- Heavy duty latches
- Wooden door frames with flush doors

### Kitchen

- Vitrified flooring with full height tiles dado
- Granite built in kitchen platform supported on kadappa
- Stainless steel sink
- UV water purifier, Geyser Et Exhaust fan (Point)
- Copper or 'C PVC concealed piping in toilets
- Angle stopcock as provision for water purifier
- Open type sink mixer
- CP jail on nahani trap
- 16 Ampere electric power points for washing machine, purifier, mixer, microwave, etc.
- Plumbing connection for washing machine/dryer and dishwasher
- Modular switches of tayama/anchor make
- Locks of reputed make
- Heavy gauge aluminum frame with tinted float glass, mosquito net
- M.S. railing for dry yard
- Magnetic door stoppers
- Heavy duty latches
- Granite door frames with flush door

### Bed Room

- Vitrified flooring
- Night Lights
- Two way switches
- P.O.P on walls cornice on the ceiling
- 20-A power points for A.C. and adequate points
- Modular switches of Tayama/anchor make
- Locks of reputed make
- heavy gauge aluminum for flower beds.
- Magnetic door stoppers
- Heavy duty latches
- Wooden door frames with flush doors

### Common Amenities

- Earthquake-resistant R.C.C. frame structure
- External wall 150 mm Th.
- Internal wall 150 mm Th.
- Fire Fighting System
- Terrace Water Proofing
- Spacious well designed and elegant entrance lobby
- Entrance lobby granite / marble flooring
- Non-skid chequered tile paving within society compound
- Rainwater Harvesting
- Lockers / drop boxes for mail/parcel/post
- High-security Gates
- Security Cabins
- Lift with power pickup
- Ample covered as well as open car parking space
- POP finish with plastic emulsion paint.

