

**PLOT 07 - TOWER NT2
TYPICAL ODD FLOOR PLAN**

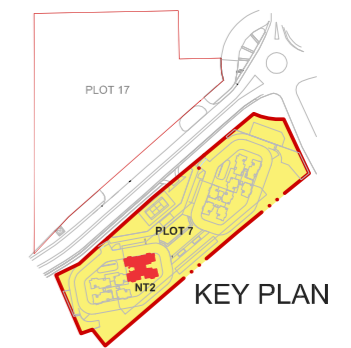

AREA STATEMENT					
(All areas in sq.mt.)					
Flat Nos.	TYPE	Carpet Area as per RERA	Total Balconies Area	Total Bay Window Area	Total Carpet Area
101,301,501,701,901,1101,1301,1501,1701,1901,2101	2 BHK - B1	68.44	7.61	1.99	78.04
102,302,502,702,902,1102,1302,1502,1702,1902,2102	2 BHK - B1	68.26	7.60	0.00	75.86
103,303,503,703,903,1103,1303,1503,1703,1903,2103	2 BHK - B1	68.37	7.60	1.26	77.23
104,304,504,704,904,1104,1304,1504,1704,1904,2104	2 BHK - B1	68.44	7.61	1.99	78.04

All areas in sq.m. (1.00 sq.m. = 10.764 sq.ft.)

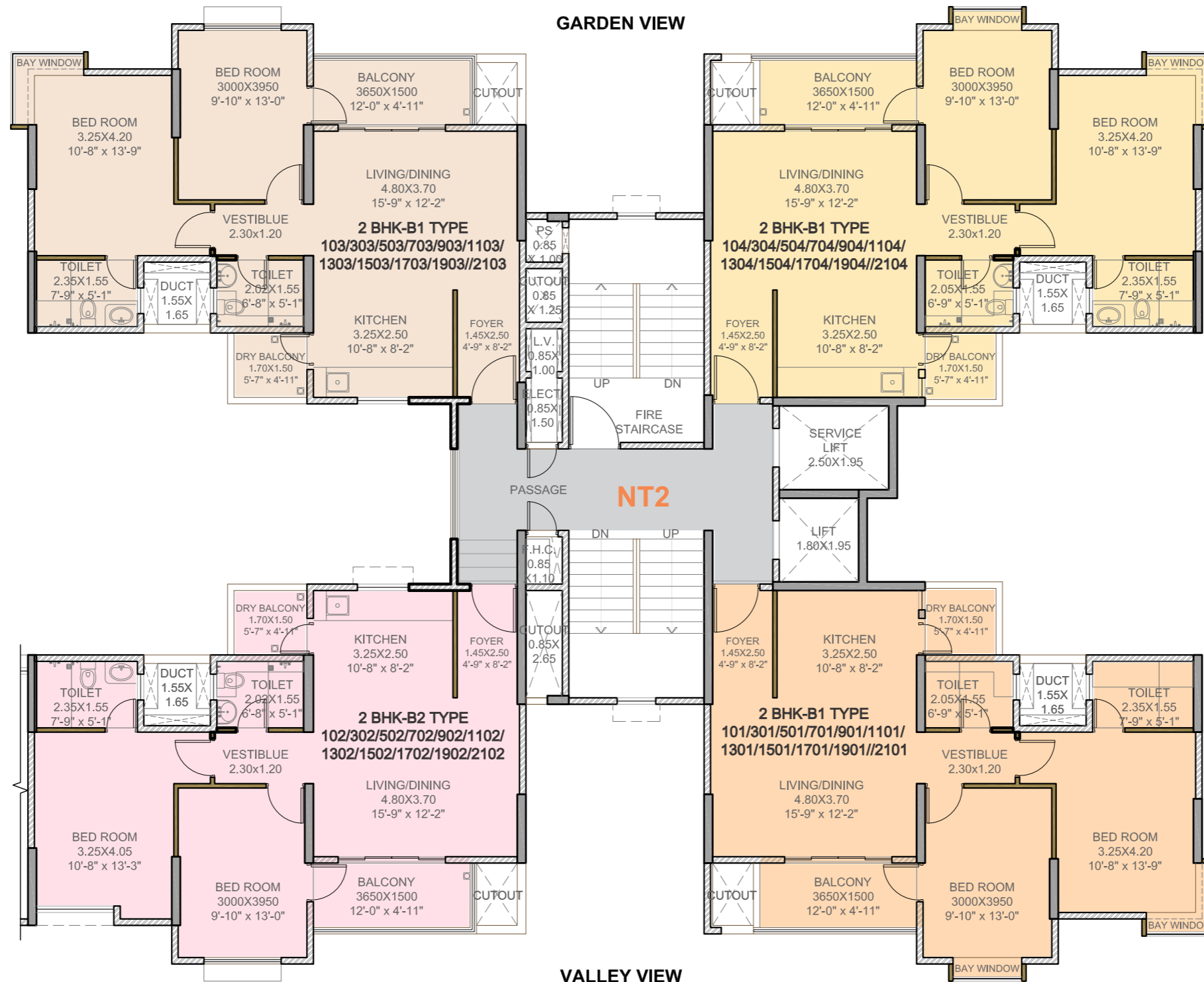

**PLOT 07 - TOWER NT2
TYPICAL EVEN FLOOR PLAN**

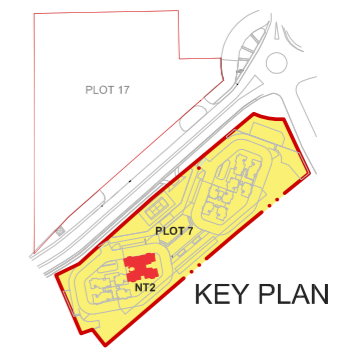
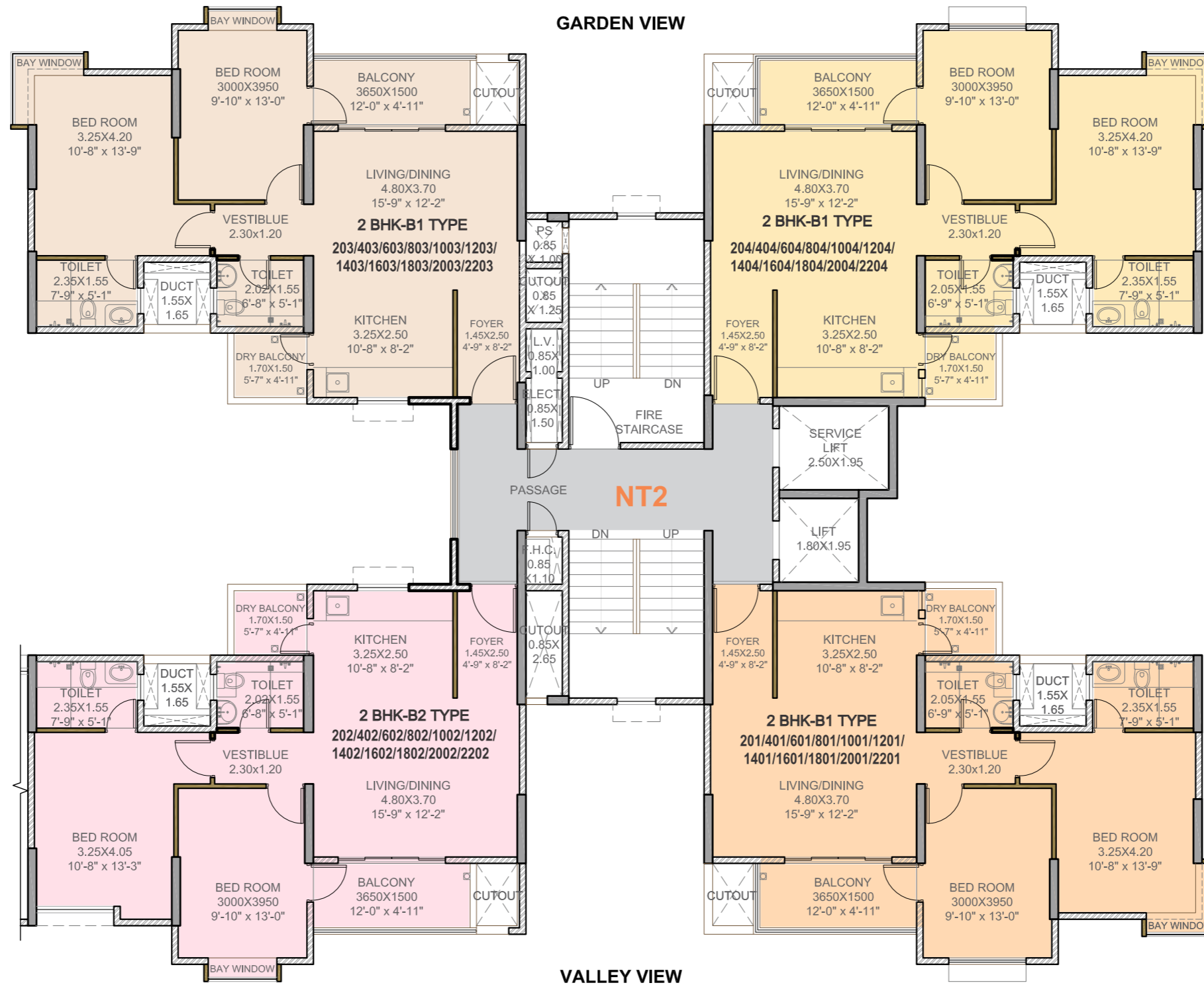

AREA STATEMENT

Flat Nos.	TYPE	Carpet Area as per RERA	Total Balconies Area	Total Bay Window Area	Total Carpet Area
201/401/601/801/1001/1201/1401/1601/1801/2001/2201	2 BHK - B1	68.44	7.61	1.26	77.31
202/402/602/802/1002/1202/1402/1602/1802/2002/2202	2 BHK - B1	68.26	7.60	0.73	76.59
203/403/603/803/1003/1203/1403/1603/1803/2003/2203	2 BHK - B1	68.37	7.60	1.99	77.96
204/404/604/804/1004/1204/1404/1604/1804/2004/2204	2 BHK - B1	68.41	7.61	1.26	77.31

All areas in sq.m. (1.00 sq.m. = 10.764 sq.ft.)

