

A Project By



Shri Jay Malhar CHS LTD, Survey No 13,  
Hissa No 5A, Nandivali Road ,  
Near Ramkrishna Bazaar, Samarth Nagar,  
Dombivli (East) 421201



sunrise6619@gmail.com



www.mahekmillennia.in



MahaRERA Registration No.: **P51700031031**  
Available at website : maharera.mahaonline.gov.in



**7666 573 573**

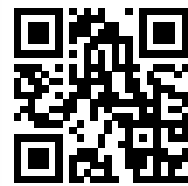

Scan the QR Code  
to Visit Website

Future icon - Kharghar | 84199 41177

# MAHEK MILLENNIA

— A NEST OF LUXURIOUS PEACE —

1, 1.5 & 2 BHK LUXURIOUS APARTMENT  
SAMARTH NAGAR, DOMBIVLI (EAST)

ARCHITECT  
**A S DASTANE AND ASSOCIATES**



RCC CONSULTANTS  
**J W CONSULTANTS LLP**



ADVOCATE  
**ADV. MANISH JAIN**



FOR THOSE WHO AIM FOR THE SKY...

### 1, 1.5 & 2 BHK LUXURIOUS APARTMENT

You've aimed high and you've got there. Now all you need is an address that suit your status. Presenting Mahek Millennia where every element has been put together to fulfill your desires. A residence so luxurious, so stylish, it clearly signals your absolute success to the world.



## PROJECT FEATURES

- › Exclusive Stilt + 17 Storey Residential Project.
- › 'A' Class construction with magnificent Architectural Elevation.
- › Earth quake resistant RCC structure.
- › Good Lightening & Ventilation in all rooms.
- › Stilt car parking.
- › Power backup for Lift parking & Passage lights.
- › Excellent planning with no wastage in all rooms.
- › 1, 1.5 & 2 BHK Luxurious Apartments.
- › Project at the Center of Optimal Proximity.
- › Located in Heart of the City.
- › High Speed Branded Elevator with Power Backup.
- › Roof Top Solar System & Rain Water Harvesting.



WELCOME TO THE LIFE OF YOUR DREAMS

## [ SPACE ]

Your home at Mahek Millennia will invite ample natural light, air ventilation and spectacular view of scenic greens. A luxurious, classy and comfortable space crafted to relish joyful moments.

## Freedom

Enjoy the company of pristine blue sky, twinkling star and cool breeze. The magnificent deck offers breathtaking view for you and your family to cherish.

Iconic in design and magnificent in scale, Mahek Millennia place at your disposal every possible facet of a great lifestyle. These luxury residences with thoughtful design and the finest amenities fulfill every dream of yours.

## Smile

Experience the joy of smiling better at Mahek Millennia.

## LOCATION

Premium Location where comfort confluence with connectivity



**LOCATION FEATURES**



**Shopping & Leisure**

- D Mart
- R K Bazaar
- Promotion Mall
- Xperia Mall
- Gopi Cine Mall
- Metro Junction Mall



**Connectivity**

- Dombivli Railway Station
- Kopar Railway Station (Diva - Vasai Route)
- Kalyan Shill Road
- Upcoming Metro Station



**Others**

- Abhinav Bank
- Axis Bank
- Nana Nani Park
- Swami Samarth Math
- Ashapura Temple
- Pimpleshwar Mahadev Temple
- Jain Temple



**Hospitals**

- Icon Hospital
- Optilife Hospital
- AIMS Hospital
- SRV Mamta Hospital
- Baj RR Hospital



**Education**

- Royal International School
- Holly Cross School
- Guardian School
- DNC School
- Pragati College
- Model College
- K V Pendharkar College



**Hotels & Fine Dining**

- Zaika Fine Dine
- Prasad Divine
- Shree Krishna Udipi
- Domino's Pizza
- Hotel Govindashram
- Classic Hotel



**1 BHK ISOMETRIC VIEW**



**1.5 BHK ISOMETRIC VIEW**



**2 BHK ISOMETRIC VIEW**

**OTHER UPCOMING INFRASTRUCTURE PROJECTS**



Mumbai Metro Line 12 Virar - Alibaug (Taloja - Kalyan)



Virar - Alibaug Corridor



Upper Thane - Dombivli Bridge



Katai - Airoli Freeway



Vasai - Kalyan Inland Waterways

In the cosmopolitan like Dombivli, where everything is compact and located far from the desired needs, The Mahek Millennia is an exclusive address bestowed with excellent connectivity. Situated in the heart of Dombivli, the prominent location of Dombivli with major schools, colleges, malls, multiplexes, banks, hospitals nearby, The Mahek Millennia is truly a world of conveniences for you. Live here and experience the world coming to you at your doorsteps.

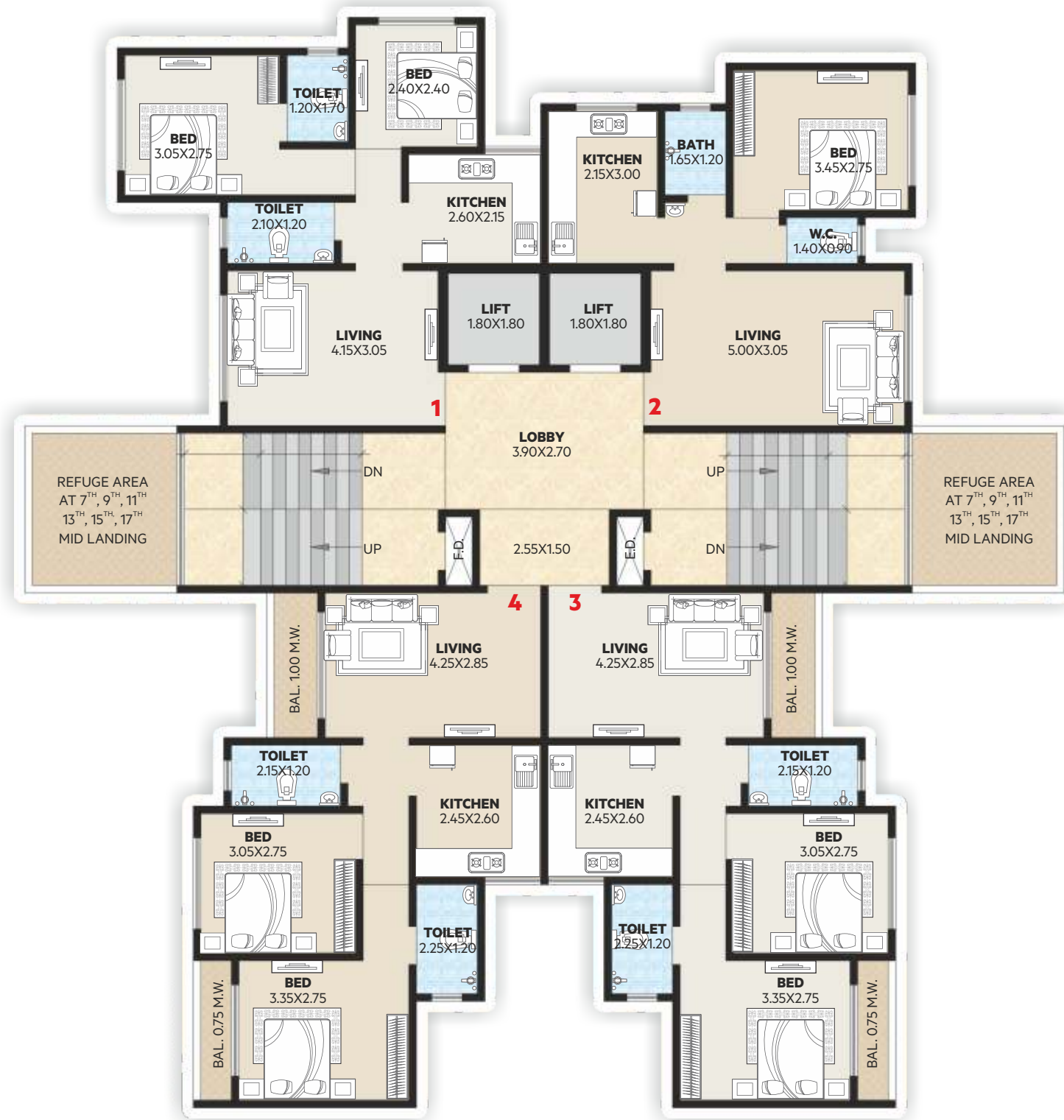
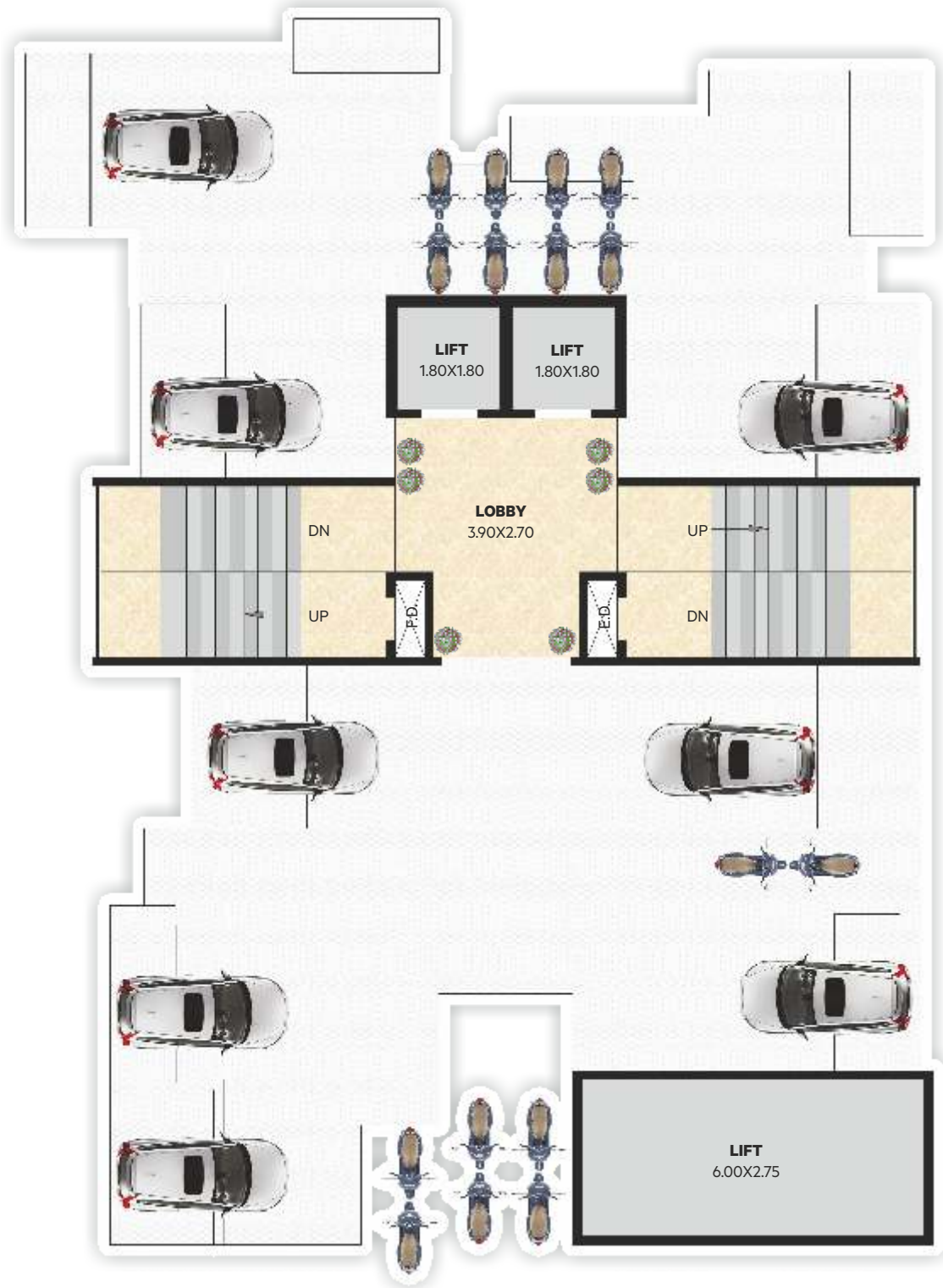

STILT FLOOR PLAN











TYPICAL FLOOR PLAN



## > A WISH FOR UNPARALLELED QUALITY

Your home at Mahek Millennia is carefully crafted like a masterpiece. With space optimising layouts, intricate care taken with the minutest detail, your home comes with top-notch specifications that capture the essence of all the comfort that you truly deserve. So come and enjoy the plus side of an elevated lifestyle!

## > SPECIFICATION

-  **Structure :**  
Earthquake resistant RCC frame structure as per structure design
-  **Finishing :**  
Internal two coat putty with emulsion paint & External plaster with 100% acrylic paint.
-  **Doors :**  
Decorative entrance door, wooden door frames for other rooms & marble door frames for bath & WC
-  **Windows :**  
Powder coated aluminum sliding windows in all the room
-  **Flooring :**  
Vitrified tiles flooring in living, bed room & kitchen
-  **Kitchen :**  
Granite platform with SS Sink and ceramic tile dado above kitchen platform
-  **Bath / WC :**  
Concealed plumbing with good quality sanitary & plumbing fitting. Ceramic tile flooring in bath/WC & glazed tiles dado up to full height
-  **Electrification :**  
Geyser point in all bathroom & concealed copper wiring with modular Switches, cable points in living room

