



DOMBIVLI EAST

THE JOURNEY OF DELIVERING THE अन COMPARABLE

Regency's Anantam journey has been one incredible journey! Only a while back, our project was first revealed to its future residents, and since then, we have made sure that every second spent was towards making your life with us, as easy, breezy and comfortable as it can get.

Ever since 12th October 2018, we have perfected every tiny detail to ensure a speedy delivery in a time span of only 1 year 10 months – including the six months of lockdown! When the world came to a halt due to these unprecedented circumstances, our mission was challenged, yet we went above and beyond to fulfil our vision of delivering your dream home, with OC received before the promised timeline. Now our hard-work has come to fruition, as you move in to your own home, only at Regency Anantam!

“When you lead a life that’s unbeatable, welcome to a lifestyle that’s uncomparable.”

- Umesh Kamat & Priya Bapat



It's a space that is incalculable. It's an expanse that is immeasurable. It spreads till the horizon. It extends up to the imagination. Between its two endless ends, lies a world, a universe. Full of dreams. Full of opportunities. Full of promises. Full of bliss, full of peace, full of life. Resplendent. Luxurious. Opulent.

अन BELIEVABLE.

अन USUAL.

अन COMPARABLE...

REGENCY
अनंत AM



PRESENTING THE अन्COMPARABLE



DOMBIVLI EAST

- Sprawled across approx. 32 acres
- All towers either facing the garden or open area / clubhouse view
- 1 & 2 BHK apartments
- Lavishly spacious homes
- All rooms with sundeck
- All rooms with air-conditioner
- 3 themed gardens
- 3 level clubhouse
- Convenient shopping

CONNECTING THE अनूतुCOMPARABLE

Travelling from one end of Regency Anantam to other may take you longer than travelling to your destination from Regency Anantam Dombivli East. Thanks to the vantage location, you are not only close to the station, but also close to schools, colleges, market, malls, hospitals, and complete social infrastructure required to live a comfortable, peaceful life. Convenience अनूतुcomparable, indeed.

RAILWAY STATIONS:

Thakurli: 2.5 kms
Dombivli: 2.9 kms
Kalyan: 5.1 kms

PROPOSED METRO:

Kalyan-Taloja Metro Line: 500 meters

COLLEGES:

KV Pendharkar College: 750 m
New Era High School & Junior College: 1.1 kms
GR Patil College: 1.9 kms
Shivajirao Jondhale College: 2 kms
Pragati College: 3 kms
Swami Vivekanand College: 3.2 kms
Holy Angels School & Junior College: 3.3 kms
Palkar College: 3.4 kms

FUEL STATIONS

Usha CNG Pump: 500 m
Techno Petrol Pump: 600 m
HP Petrol Pump: 700 m
India Oil & CNG: 900 m

SCHOOLS:

Narayana E-Techno School: Within premises
Omkar Cambridge Internation School: 1 km
NES International School: 1.7 kms
Royal International School: 3.3 kms
Hello Kids Divine: 3.7 kms
Guardian School: 3.7 kms
Vidya Niketan School: 4.1 kms
Ira Global School: 4.8 kms
St. Theresa Convent School: 5 kms

HOSPITALS:

AIMS Hospital: 900 meters
Kamat Hospital for Women: 1.1 kms
Neptune Super Speciality: 1.2 kms
Shivam Hospital: 1.8 kms
Maltri Charitable Trust: 2.1 kms

COMMERCIAL/SHOPPING:

GNP Galleria: 230 m
Metro Junction Mall: 3 kms
D Mart: 3.6 kms
Xperia Mall: 6.8 kms

BANKS:

HDFC Bank: 700 m
PMC Bank: 1.7 kms
SBI Dombivli East Branch: 2.3 kms
Andhra Bank: 2.4 kms
Axis Bank: 3 kms
Dombivli Nagari Sahakari Bank: 3.2 kms
Greater Bank: 3.8 kms
Allahabad Bank: 4.2 kms

TEMPLES:

Gavdevi Mandir: 2 kms
Mahadev Mandir: 2.3 kms
Shree Gaandevi Mandir: 2.7 kms
Shaptashrungi Devi Temple: 3.2 kms
Datta Mandir: 3.2 kms
Shani Mandir: 3.5 kms

RESTAURANTS:

Nandi Palace: 210 meters
Suyog Hotel: 400 meters
Prasad Food Divine: 2.8 kms
Dominos Pizza: 2.9 kms



Source: Google Maps. Not to Scale.

FLAUNTING THE अन COMPARABLE

This first chapter of Regency Anantam is just the precursor to its vast magnitude. In the entire Regency Anantam, the first phase occupies a place of significance and prominence. A picture of perfection in terms of planning, design and layout, Regency Anantam has a perfectly balanced life to lifestyle ratio. Layouting of Regency Anantam is *अन*comparable, indeed.







(A) ENTRANCE GATE



(D) SOCIAL GARDEN



(B) TEMPLE



(E) CLUBHOUSE



(C) SPORTS GARDEN



(F) LEISURE GARDEN



Phase I Bldg No.	11, 12, 13, 14, 15, 16, 17
Phase II Bldg No.	6, 7, 8, 9, 10, 18, 19
Phase III Bldg No.	1, 2, 3, 4, 20, 21, 22
Phase IV Bldg No.	5, 23

The layout plan shown above is indicative of the proposed development of the project in several various phases. The Proprietors / Developers reserve the right to make structural, electrical, mechanical, plumbing or other modifications to the layout, location, plan, elevation, perspective view, of buildings, garden, parks, swimming, clubhouse, tennis, etc. Design of buildings / towers, garden, club, club house, internal road, other infrastructures, etc. without any notice or obligation and it may be located either by the local authorities with its planning / approval. Plans and/or specifications shown here may be time and/or may be deemed fit by the Developer in the interest of orderly development / improvement.



ENTERING THE अनCOMPARABLE

If you thought this is an entrance gate to Regency Anantam, think again. It is, in fact, the threshold to the life of an अनcomparable magnitude. Beyond this point begins the unending world of ageless luxury and aristocracy. Step in, and discover what eternity has in stored for you. Entering in Regency Anantam is अनcomparable, indeed.



SURROUNDING THE अन COMPARABLE

SOCIAL GARDEN

- Joggers Track
- Cycling Track
- Children's Play
- Amphitheater

The first phase of Regency Anantam is an island of greenery. THREE BEAUTIFULLY LANDSCAPED THEMED GARDENS surrounding the magnificent towers. A sight to behold, an experience to explore. With one of the themed gardens hosting the grand Gr.+2 storey clubhouse, luxury comes full circle. Natural elegance in Regency Anantam is unparalleled, indeed.



SPORTS GARDEN

- Jogger's track
- Jasmine creepers on periphery
- Bamboo plantation at the corners
- Foxtail palms at periphery
- Lawn
- Gazebo
- Stepped seating
- Benches
- Grass pavers
- Mounds with palms
- Special two - way seating
- Shrubs on edge
- Box cricket
- Tennis court
- Multipurpose court
- Chain link fencing with plantation
- Skating Rink



LEISURE GARDEN

- Jogger's park
- Pathway feature
- Trellis
- Senior citizen zone
- Green walkers
- Acupressure pathway
- Yoga/meditation pavilion
- Square planters with seating
- Mounds with palms
- Zen garden
- Feature landscaped circle with seating
- Butterfly garden
- Creepers in the edge flowerbed
- Bamboo plantation at the corners



ENJOYING THE अनू COMPARABLE

DIVIDED INTO 3 LEVELS; lower ground, ground and upper level; the clubhouse of Regency Anantam - CLUB INFINITI - is expansive in size and majestic in ambiance. Surrounded by the luxuriously green Leisure Garden on the outside and brimming with bottomless fun, entertainment and pleasure, Club Infiniti is where enjoyment knows no bounds. Enjoying in Regency Anantam is अनू comparable, indeed.



Anil's Impression of Club INFINITI as on 2nd Oct. 2018

LOWER
GROUND
LEVEL



- SWIMMING POOL WITH DECK AREA
- FUN POOL WITH RAIN SHOWER
- KIDS' POOL
- MINI-THEATRE
- BADMINTON COURT - 2 NOS.
- STEAM AND MASSAGE ROOMS (LADIES AND GENTS SEPARATE)
- LADIES PARLOUR
- SQUASH COURT



Massage Room

Kit'sa's perspective of Massage Room as on 18th Sept. 2019



Ladies Parlour

Kit'sa's perspective of Ladies Parlour as on 18th Sept. 2019



Mini-Theatre

Spock's image used for representation purposes only



Badminton Court

Kit'sa's perspective as on 18th Sept. 2019



Kit'sa's perspective of the building as on 18th Sept. 2019

GROUND LEVEL



- DOUBLE HEIGHT ENTRANCE LOBBY WITH RECEPTION
- COMMUNITY HALL WITH KITCHEN, LAWN & WAITING AREA
- CENTRAL ATTRACTIVE OVAL GYMNASIUM ABOVE SWIMMING POOL FOR UNISEX
- CRÈCHE ROOM WITH WAITING AREA
- SEPARATE GENTS & LADIES GYMNASIUM
- BUSINESS CENTER
- AEROBICS / ZUMBA
- GARDEN SIT OUT



UPPER LEVEL FLOOR



- INDOOR GAMES (CHESS, SNOOKER, TABLE TENNIS, CARROM, BILLIARDS ETC.)
- MEDITATION / YOGA ROOM
- 3D VIDEO PARLOUR FOR KIDS / ADULTS
- MUSIC ROOM
- CAFETERIA WITH LIBRARY
- INDOOR AND OUTDOOR CAFETERIA CONNECTED TO KITCHEN
- 12D THEATRE
- GOLF SIMULATOR
- NET CRICKET



Video Games

Void Image used for representational purposes only



Games Room

Libby's Inspiration of Games Room on 18th Sept 2016



Cafeteria

Void Image used for representational purposes only

LIVING THE अनCOMPARABLE

Beginning from the lobby and ending inside your apartment, you discover what it is to live in an infinite world of opulence. Select the apartment of your choice - garden facing or the one offering unhindered views - you breathe aristocracy standing on the decks that come attached to every room. Living in Regency Anantam is अनूcomparable, indeed.



BEHOLDING THE अनCOMPARABLE

Looking at the endlessness of the infinite Regency Anantam from the boundaries of THE SUNDECK ATTACHED TO YOUR FULLY AIR-CONDITIONED HOME is certainly a humbling experience.

LIVING

FLOORING

- 800 mm X 800 mm branded vitrified tiles
- Branded tiles for flooring in sun deck

WALL FINISHING

- Internal walls with gypsum finish
- Decorative ceiling in the flat
- Plastic emulsion paint in the entire flat
- Oil paint in bathrooms above the lintel level

DOOR

- Good quality wooden frame with oil paint finish
- Designer flush doors with both side laminate & decorative fitting

WINDOW

- Color anodized aluminum sliding windows
- Mosquito net shutter in all windows
- Photo frame, granite window sill in entire flat

ELECTRIFICATION

- Concealed copper wiring with circuit breakers
- Fans and tube lights
- Split AC in all the bedroom & living area
- Telephone and cable TV points
- Inverter provision
- Video door provision

BEDROOM

FLOORING

- 800 mm X 800 mm branded vitrified tiles
- Branded tiles for flooring in sun deck

DOORS

- Good quality wooden frame with oil paint finish
- Designer flush doors with both side laminate & decorative fitting

WINDOW

- Color anodized aluminum sliding windows
- Mosquito net shutter in all windows
- Photo frame, granite window sill in entire flat

WALL FINISHING

- Internal walls with gypsum finish
- Decorative ceiling in the flat
- Plastic emulsion paint

ELECTRIFICATION

- Concealed copper wiring with circuit breakers
- Fans and tube lights
- Split AC in all the bedroom & living area
- Telephone and cable TV points

BATHROOMS

- Solar water connection in each flat
- One geyser in each flat of reputed brand
- C/PVC concealed piping
- Designer tile flooring and dado up to lintel level
- Oil paint in bathrooms above the lintel level
- Jaquar or equivalent brand CP fittings
- Best quality sanitary ware with flush valve
- Tube light and mirror in all bathrooms
- Exhaust fan in all bathrooms
- Washbasin with granite counter in all bathrooms

KITCHEN

- Parallel kitchen granite platform with SS sink and drain board
- Water purifier of reputed brand
- Grills provided in kitchen
- Designer tile dado above platform up to lintel level
- Designer tile in the deck up to lintel level
- R.C.C. loft in kitchen
- Washing machine provision in kitchen sun deck
- Granite stone fixed for water dispenser



ACTUAL VIEW COMBINED WITH STOCK IMAGE

TYPICAL FLOOR PLAN 2 BHK

BUILDING NAME	ALPINE	BEGONIA	BONICA	CAESAR	CATALINA	CORNEL
BUILDING NO.	1	3	6	7	8	10

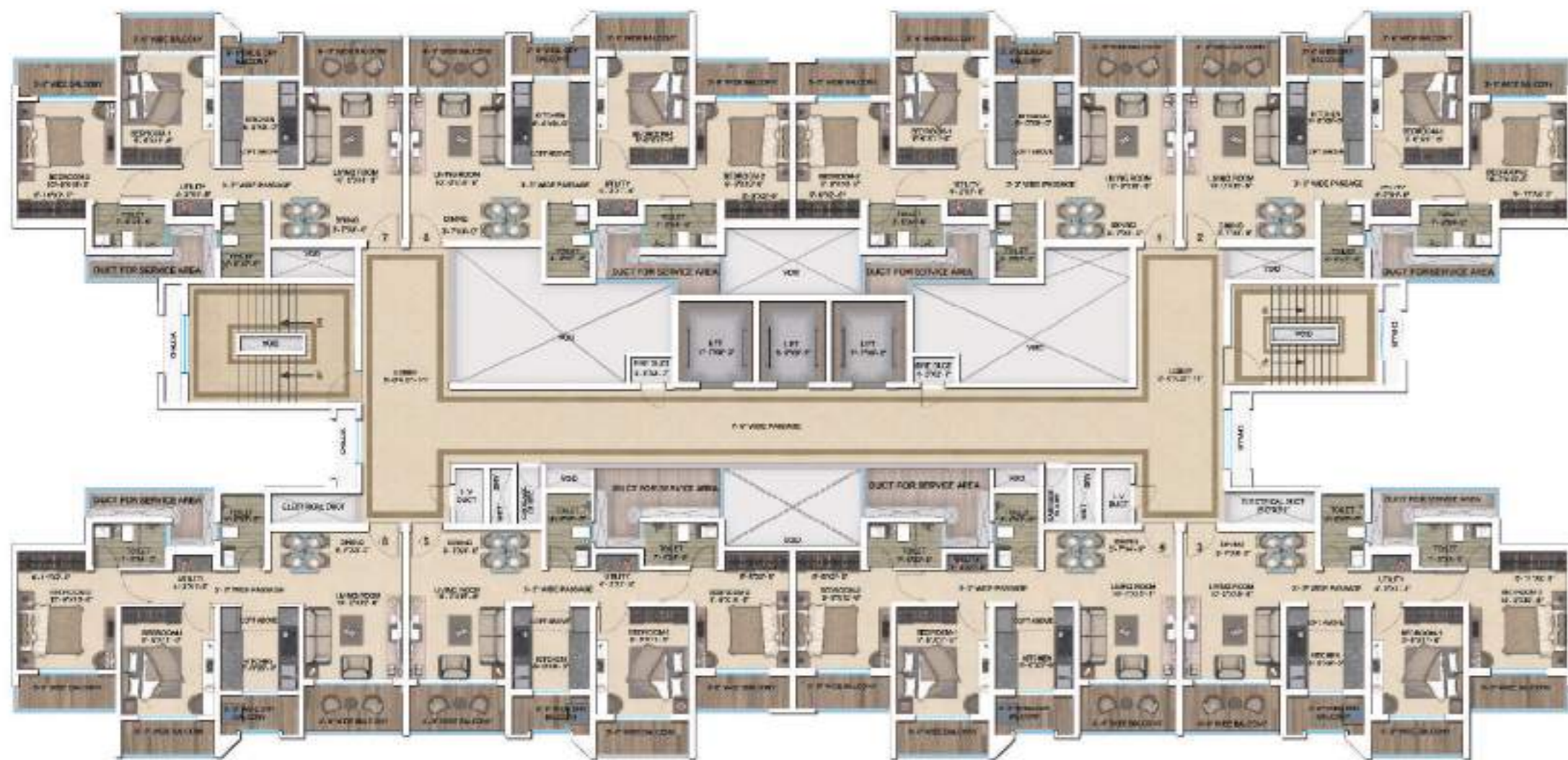

Please Note: All Dimensions mentioned in the unit plan are in feet. All dimensions of carpet area are from finished wall surface. Minor variations/tolerances of +/- 3% in carpet area may occur on account of design and/or construction exigencies.



2 BHK UNIT PLAN

CARPET AREA = 59.50 SQ. MTS.
BALCONY AREA = 13.20 SQ. MTS.

2 BHK 3D PLAN

Please Note: All Dimensions mentioned in the unit plan are in feet. All dimensions of carpet area are from finished wall surface. Minor variations/tolerances of +/- 3% in carpet area may occur on account of design and/or construction exigencies.

TYPICAL FLOOR PLAN 1 BHK

BUILDING NAME	BLUEBELL	ASPEN	MOLINIA	PRIMROSE	ROSALYN	ROSEMARY	ZINNIA
BUILDING NO.	2	5	18	20	21	22	23

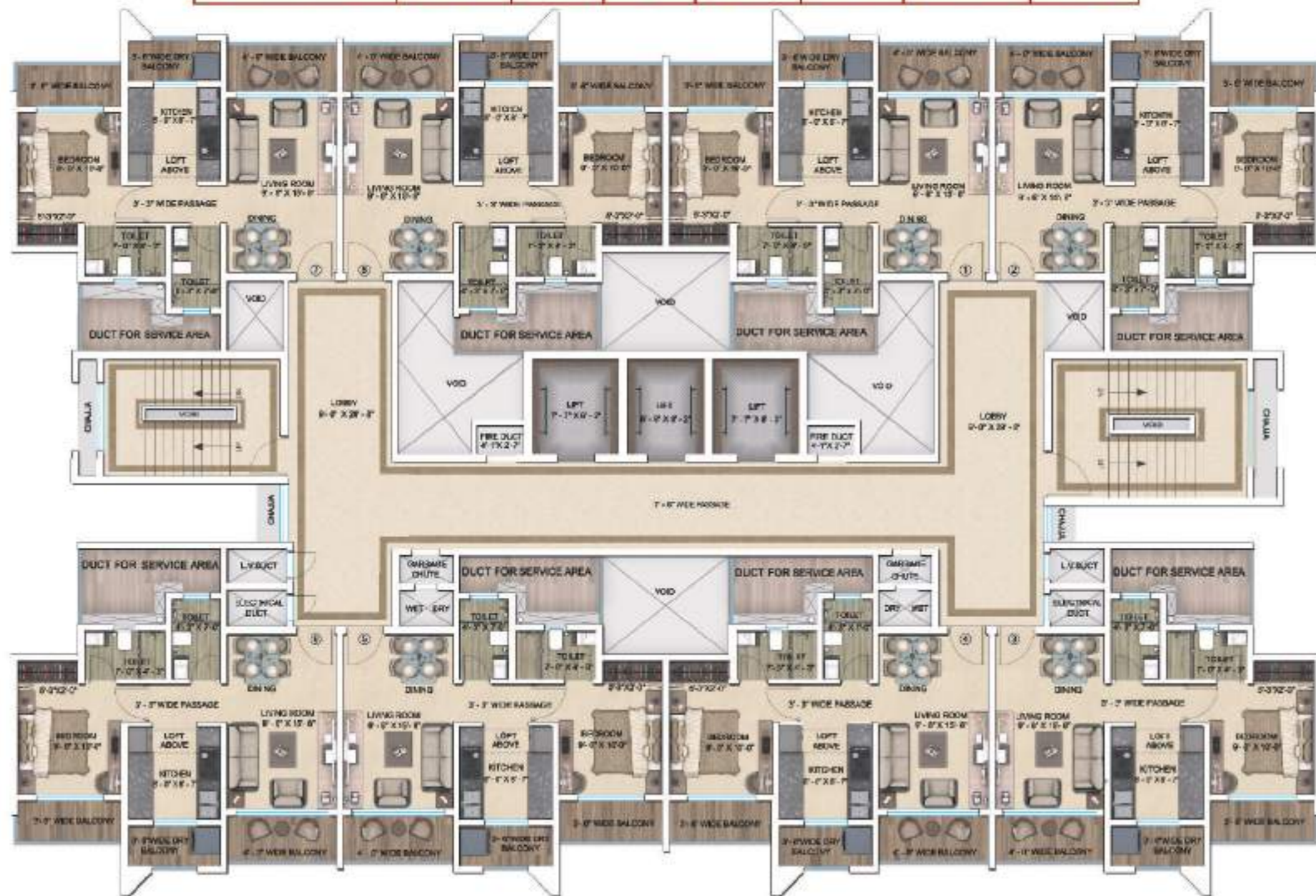

Please Note: All Dimensions mentioned in the unit plans are in feet. All dimensions of carpet area are from finished wall surfaces. Minor variations/tolerances of +/- 3% in carpet area may occur on account of design and/or construction variances.



1 BHK 3D PLAN



1 BHK UNIT PLAN

CARPET AREA - 40.00 SQ. MTS.
BALCONY AREA - 9.00 SQ. MTS.

Please Note: All Dimensions mentioned in the unit plans are in feet. All dimensions of carpet area are from finished wall surfaces. Minor variations/tolerances of +/- 3% in carpet area may occur on account of design and/or construction variances.

PARTNERING WITH THE अनूत COMPARABLE

DESIGN ARCHITECT & INTERIORS

AR. RAJAN GOREGAOKER
AR. SACHIN GOREGAOKER
GA DESIGN

LIASONING ARCHITECT

AR. ANIL NIRGUDE
VITAN CONSULTANTS

LANDSCAPE ARCHITECT

AR. SWATI JOSHI
DREAMSCAPES

STRUCTURAL CONSULTANT

JW (JOSHI AND WATVE)
M/S JW CONSULTANTS LLP

DRAINAGE AND PLUMBING CONSULTANT

MR. ASHOK SHETH
SHEETAL ENVIRONS PVT. LTD.

ELECTRICAL CONSULTANT

MR. SHEKHAR BAHULEKAR
BAHULEKAR & ASSOCIATE

FIRE CONSULTANT

MR. SUBODH PARTE
AJINKYA FIRE PROTECTION SYSTEMS

STP CONSULTANT

TECHNICHE ENGINEERING PRIVATE LIMITED

ENVIRONMENT CONSULTANT BUILDING ENVIRONMENT

MARKETING ADVISOR
MR. JAIDEEP GANDHI

ADVERTISING CONSULTANT

MR. KAMLESH SHARMA
I'AM ICON

VAASTU CONSULTANT

DR. ARUN KUMAR BOPANA

3D RENDERING

MR. DIPESH SARAF
ANCIENTCAD STUDIO



COMPLETED
PROJECTS

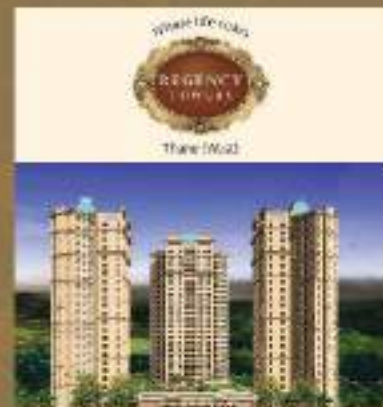
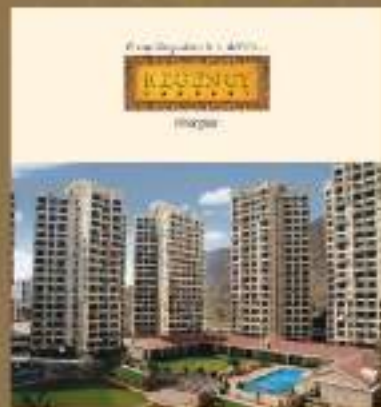
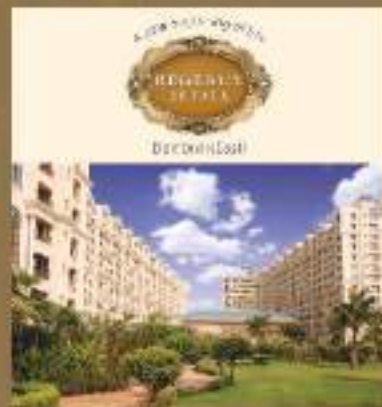

ONGOING PROJECTS

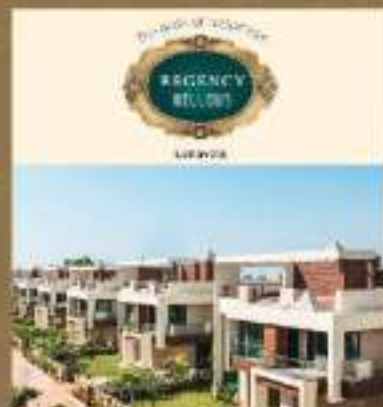
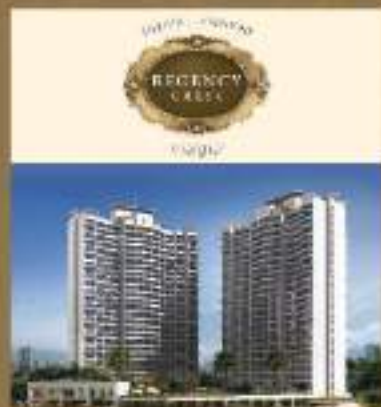
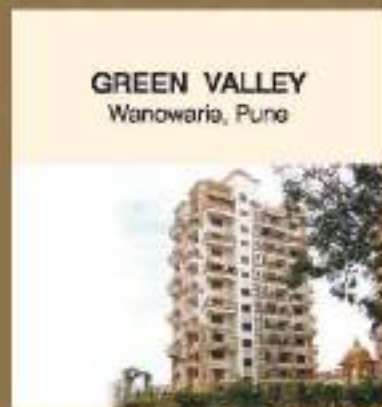

OVER 20 YEARS OF REALTY
 13 MILLION SQ. FT.
 OVER 20 PROJECTS
 17,000+ FAMILIES

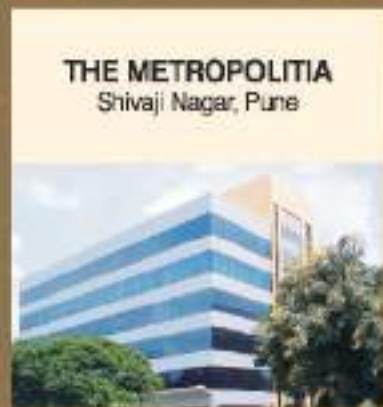
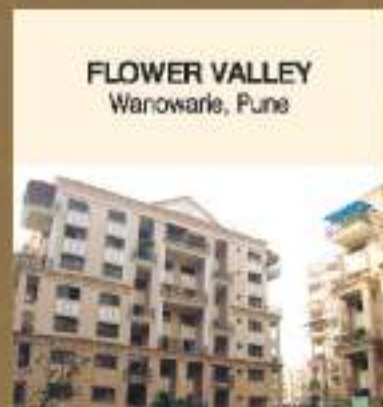
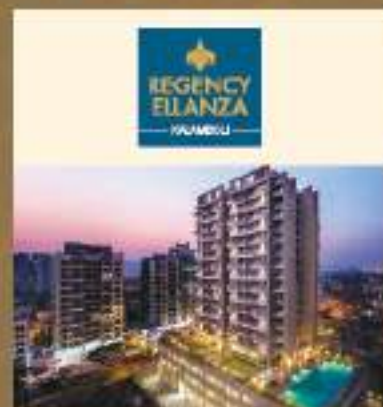

UPCOMING
PROJECTS

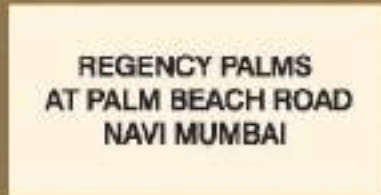

Above details are as on September 2021



Site Address: Regency Anantam, Kalyan-Shil Road, Vicco Naka, Dombivli (E) - 421 203

Corporate Address: Regency Nirman Limited, Regency House, Near Aman Talkies, Ulhasnagar - 421 002

Call: 0251 2808081 | www.regencygroup.co.in | sales@regencyanantam.com



The project Regency Anantam has been registered via Maharegta reg. no.: **P51700017874** (Phase 1), **P51700020185** (Phase 2) & **P51700020194** (Phase 3) and is available on website - <https://maharegta.mahaonine.gov.in> under registered projects.



Scan for the
360° Experience

Disclaimer: All the images, pictorials, visuals, elevations, perspectives, illustrations, model, specifications, plans, designs, drawings, dimensions, maps, location, amenities, features, and other information / details herein are conceptual, indicative and for representation purposes only and are not to scale, and is subject to the approval of the respective authorities. The Promoters / Developers / Architect reserve the right to add, alter, delete or replace any of these in the course of the development, without any notice or obligation. This printed material does not constitute an offer or contract of any nature whatsoever between the Promoters / Developers and the recipient. All transactions in this development shall be subject to and governed by the terms & conditions of the Agreement for Sale to be entered into between the parties.