



PRAJAPATI™
Ornate
— Luxurious Living —



Luxury living, just 5 minutes drive
from the station.



3rd Floor - Amenities view

Luxurious Living

Explore a new world by experiencing ultramodern and hi-tech amenities in homes beautifully designed and meticulously planned for your comfort. Adorn the crown of luxury and peaceful living. Indulge in a world full of bliss and rejoice in its magnificence at your abode in the heart of Panvel city with unhindered view of mountains for life.

Experience finest luxury at Prajapati Ornate, a lifestyle designed for your comfort.

Prajapati Ornate

Commercial and Residential tower comprising of 3 wings.

- Ground floor - Commercial Shops
- First floor - Commercial Units
- Second floor - Stilt Parking
- Third floor - Podium level Amenities
- 4th to 15th floors - Residential Units

Amenities:

- Spacious 2 & 3 BHK Apartments
- Location in the Heart of New Panvel
- Infinity Pool with Sunbath Deck Area
- Separate Pool for Kids
- Jogging Track
- Lush Green Party Lawn with Stage
- Fitness Centre
- Open Aerobics and Yoga Deck
- Juice Bar
- Community Hall and TV lounge
- Kids Playing Area and Tot Lot
- Indoor Game and Recreational Area
- Exclusive Entrance Lobby
- Wide Changing Rooms for Comfort
- Multiple Indoor and Outdoor Seating Areas
- East - West Facing Flats
- Unhindered view of Mountains



Individual 2 BHK Plan



Individual 3 BHK Plan



Floor Plan

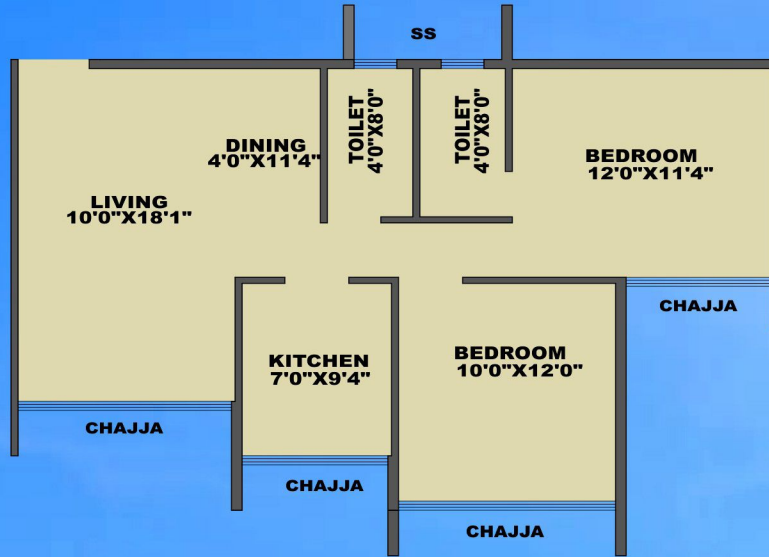

2 BHK

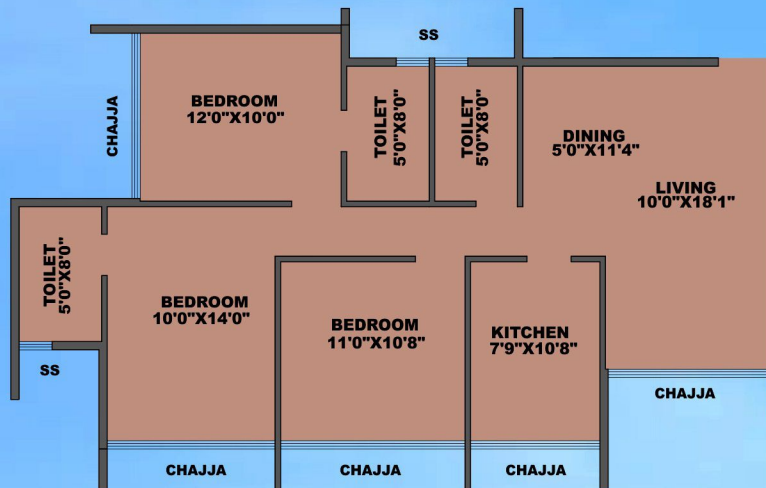

3 BHK

Location Advantages

- Prime Location - In the heart of New Panvel (E) • 1.5 kms away from Panvel railway station
- CIDCO Node with fully developed infrastructure • 9 kms from upcoming Navi Mumbai Airport
- Quick access to Mumbai - Pune express highway • The next commercial hotspot in New Panvel
 - 4 lane road in front and 2 lane road at the back of the building

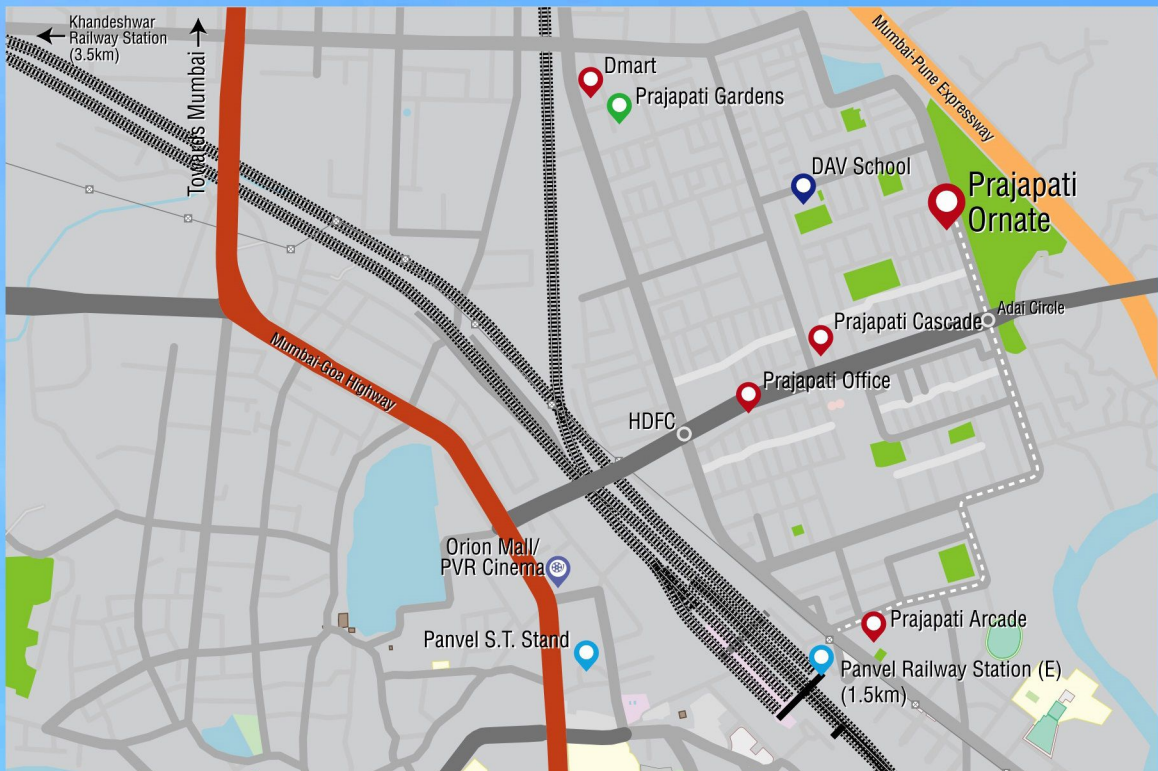

Ornate: Sector 10, Opp. Rajiv Gandhi Maidan, New Panvel (E), Navi Mumbai.

Office: Plot - 13/B, Sec - 19, New Panvel, Navi Mumbai - 410 206.

MahaRERA Number: P52000019057 | maharera.mahaonline.gov.in

Call: 8080 5040 56 | **Web:** www.prajapatigroup.com | **Email:** info@prajapatigroup.com

