

The Pride
of Kalyan

CODE NAME:

KRISHNA
ULTIMA



All roads lead to pride.

Yes! Finally, the home of your dreams is coming up right here in Kalyan. With ultramodern amenities, locational advantages and lifestyle conveniences, you can invite guests with pride.

• Easy Commute

- 2.5 KM KALYAN STATION
- 3.5 KM VITTALWADI STATION
- 5.6 KM ULHASNAGAR STATION
- 6.3 KM DOMBIVALI STATION
- 4.7 KM TAKURLI STATION

• Shopping & Entertainment

- 3.3 KM D MART
- 1.9 KM METRO MALL
- 2.0 KM BIG BAZAR
- 9.5 KM PALAVA XPERIA MALL

• Healthcare

- 3.1 KM FORTIS HOSPITAL
- 5.5 KM MEERA HOSPITAL
- 3.3 KM AM-PM HOSPITAL

• Education

- 4.8 KM OMKAR SCHOOL CBSE
- 2.5 KM ARYA GURUKUL SCHOOL CBSE

• Banking

- 2.2 KM BANK OF BARODA
- 2.5 KM AXIS BANK
- 1.5 KM ICICI BANK

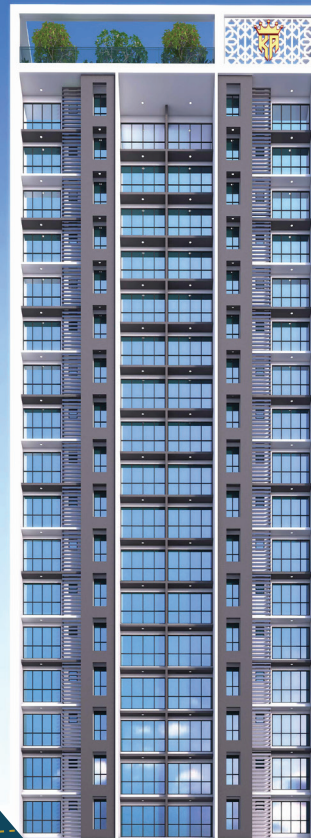

Reasons for pride, studded all around your home.

Amaze your guests with attractions like hi-tech home automation, rooftop garden, Gazebo, fitness and Yoga centres, 24X7 Wi-Fi connection around all common areas. Wherever you are at Krishna ULTIMA, there's something to feel proud of.



External Amenities



Ground floor

- Grand entrance lobby with free WIFI
- Landscape and Tree planting
- Stack and covered parking
- Security cabin
- Society office



Terrace level

- Roof top garden
- Child en play area
- Gazebo
- Senior citizens sit-out area
- Free WIFI corner
- Jogging track

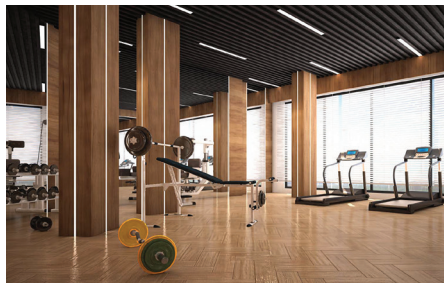

3rd Podium level

- Fitness centre
- Indoor games
- Yoga centre



Internal Amenities



- Home automation
- Alexa for controlling lights
- Digital lock and video door phone
- Motion Sensor Lights in Washrooms
- Modular kitchen
- Water purifier and Exhaust fan
- 3 track aluminum windows with heavy sections

- Pine wood doors for Hall, Kitchen and Bedroom
- Vitrified tiles for all rooms and antiskid tiles for Balcony and toilets
- Granite kitchen platform
- Branded CP and Sanitary fittings
- Acrylic Emulsion painting
- Electrical fittings – Polycab wiring, Legrand switches and Syska light fixtures

Other Amenities

- KDMC water supply
- Rainwater harvesting
- Modern firefighting system
- Power back up
- Solar panels for green energy

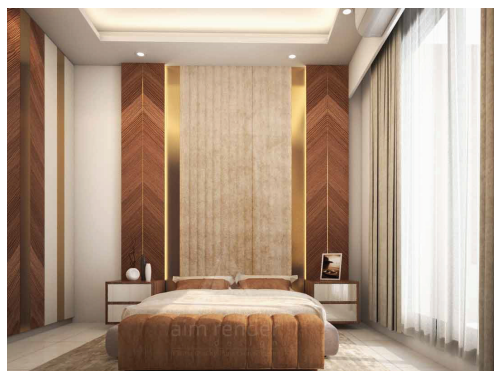

A project by Sonawane Group



SONAWANE
Life's futuristic

Sales office: Tisgaon Road, Beside Krishna Nisarag, Santosh Nagar, Kalyan (E), Maharashtra - 421306.
Contact Us: **82919 35835**

Corporate office: Sonawane Corporate, KRISHNA PARADISE, A2, 100 Feet Rd, Kalyan (East) Kalyan,
Maharashtra - 421306. Contact Us: **876 708 8880**



This project is registered as 'Krishna Anand' with
MahaRERA Registration No. P51700031006 situated at S No. 44/1, Village Tisgaon,
Kalyan East. Details available at website <https://maharera.mahaonline.gov.in>

Disclaimer and T & C: Amenities and other facilities shown in all communication elements shall be ready only at the time of completion of the entire project. The pictorial depiction of the amenities, elevation and other facilities are indicative in nature and do not represent the final look, feel and size of the facilities provided.